

Current Availabilities as of September 2012

State	Market	Address	City	Industrial/ Office/ Cold Storage	Availabilities (SF)		Clear Height	Listing Broker Contact	Broker Email
					Total	Minimum			
AZ	Southwest Phoenix	4901 W. Van Buren St.	Phoenix	I	5,780	5,780	18'	Marc Hertzberg - Jones Lang LaSalle (602) 648-9219	<a href="mailto:marc.hertzberg@am.jll.com">marc.hertzberg@am.jll.com</a>
		4929 W. Van Buren St.	Phoenix	I	74,642	37,321	24'	Marc Hertzberg - Jones Lang LaSalle (602) 648-9219	<a href="mailto:marc.hertzberg@am.jll.com">marc.hertzberg@am.jll.com</a>
		6111 W. Washington St. (Land/BTS)	Phoenix	I	273,000	114,000	32'-36'	John Werstler - CBRE (602) 735-5504	<a href="mailto:john.werstler@cbre.com">john.werstler@cbre.com</a>
CA	Los Angeles	24760 S Main St.	Carson	I	231,008	231,008	30'	John Repstad - Binswanger (213) 892-8881	<a href="mailto:jrepstad@raginc.com">jrepstad@raginc.com</a>
		12632 Monarch St	Garden Grove	I	61,225	20,000	27'	Bob Goodmanson - CBRE	<a href="mailto:bob.goodmanson@cbre.com">bob.goodmanson@cbre.com</a>
		2 Goodyear Ave	Irvine	R&D	26,462	26,462	20'	Trent Walker - Voit Commercial Brokerage (949) 851-5100	<a href="mailto:TWalker@voitco.com">TWalker@voitco.com</a>
		1551 E Victoria St.	Carson	I	101,826	101,826	30'	John Schumacher - CBRE (310) 363-4960	<a href="mailto:John.Schumacher@cbre.com">John.Schumacher@cbre.com</a>
		1601 W. Mission Blvd.	Pomona	I	751,528	32,220	12'-20'	John Repstad - Binswanger (213) 892-8881	<a href="mailto:jrepstad@raginc.com">jrepstad@raginc.com</a>
		13083 Slover Ave	Fontana	I	323,660	323,660	32'	Chuck Belden - Cushman & Wakefield (909) 942-4640	<a href="mailto:chuck.belden@cushwake.com">chuck.belden@cushwake.com</a>
		6100 Garfield Ave (Land/BTS)	Commerce	I	620,000	152,000	36'	Zac Sakowski - JLL (213) 239-6239	<a href="mailto:zac.sakowski@am.jll.com">zac.sakowski@am.jll.com</a>
		775 W. Manville	Compton	I	116,263	116,263	22'	Rooney Daschbach - Cushman & Wakefield (562) 276-1431	<a href="mailto:rooney.daschbach@cushwake.com">rooney.daschbach@cushwake.com</a>
		675 W. Manville	Compton	I	123,456	123,456	22'	Rooney Daschbach - Cushman & Wakefield (562) 276-1431	<a href="mailto:rooney.daschbach@cushwake.com">rooney.daschbach@cushwake.com</a>
		775 - 675 W. Manville St.	Compton	I	239,719	116,263	22'	Rooney Daschbach - Cushman & Wakefield (562) 276-1431	<a href="mailto:rooney.daschbach@cushwake.com">rooney.daschbach@cushwake.com</a>
		350 W. Manville St.	Compton	I	50,000	50,000	24'	Brad Levin - Daum Commercial (310) 538-6728	<a href="mailto:brad.levin@daumcommercial.com">brad.levin@daumcommercial.com</a>
		9425 Nevada St.	Redlands	I	390,780	187,673	32'	Chuck Belden - Cushman & Wakefield (909) 942-4640	<a href="mailto:chuck.belden@cushwake.com">chuck.belden@cushwake.com</a>
		9910 Nevada St. (Land/BTS)	Redlands	I	425,940	425,940	32'	Jeff Smith - Lee & Associates (909) 373-2909	<a href="mailto:jsmith@lee-assoc.com">jsmith@lee-assoc.com</a>
CA	Bay Area	4422 Airport Dr.	Ontario	I	25,488	25,488	26'	Len Santoro - CBRE (909) 418-2158	<a href="mailto:len.santoro@cbre.com">len.santoro@cbre.com</a>
		8000 Central Ave.	Newark	I/O	28,904	14,000	20'-23'	Joe Kelly - CBRE (408) 453-7474	<a href="mailto:joe.kelly@cbre.com">joe.kelly@cbre.com</a>
		33200 Lewis Ave.	Union City	I	31,500	31,500	24'	Kevin Hatcher - Colliers (510) 433-5818	<a href="mailto:kevin.hatcher@colliers.com">kevin.hatcher@colliers.com</a>
FL	Southeast Florida	1001 Broken Sound Pkwy.	Boca Raton	I/O	10,250	10,250	16'	Jeff Kelly - CBRE (561) 393-1621	<a href="mailto:jeffrey.kelly@cbre.com">jeffrey.kelly@cbre.com</a>
		1155 Broken Sound Pkwy.	Boca Raton	I/O	42,563	11,351	16'	Jeff Kelly - CBRE (561) 393-1621	<a href="mailto:jeffrey.kelly@cbre.com">jeffrey.kelly@cbre.com</a>
		1225 Broken Sound Pkwy.	Boca Raton	I/O	5,720	5,720	16'	Jeff Kelly - CBRE (561) 393-1621	<a href="mailto:jeffrey.kelly@cbre.com">jeffrey.kelly@cbre.com</a>
		4935 Park Ridge Blvd	Boynton Beach	I	22,735	22,735	18'	Christopher Thomson - Cushman & Wakefield (561) 227-2020	<a href="mailto:christopher.thomson@cushwake.com">christopher.thomson@cushwake.com</a>
		1335 W. 53rd St.	Mangonia Park	I	27,265	7,500	24'	Robert Smith - CBRE (561) 393-1608	<a href="mailto:robert.c.smith@cbre.com">robert.c.smith@cbre.com</a>
		1395 NW 17th Ave.	Delray Beach	I/O	3,930	1,930	20'	Christopher Thomson - Cushman & Wakefield (561) 227-2020	<a href="mailto:christopher.thomson@cushwake.com">christopher.thomson@cushwake.com</a>
		430 S. Congress Ave.	Delray Beach	I	41,334	9,013	24'	Jeff Kelly - CBRE (561) 393-1621	<a href="mailto:jeffrey.kelly@cbre.com">jeffrey.kelly@cbre.com</a>
		251 International Pkwy. (Sublet)	Sunrise	I	178,791	178,791	40'	Brad Stitchberry - KTR Capital Partners (954) 421-0948	<a href="mailto:bstitchberry@ktrcapital.com">bstitchberry@ktrcapital.com</a>
		602 - 668 S. Military Trl.	Deerfield Beach	I/O	25,024	1,843	16'	Tom Hotz - Butters Realty (954) 312-2415	<a href="mailto:tom@butters.com">tom@butters.com</a>
		700 - 710 S. Military Trl.	Deerfield Beach	I	30,850	12,739	18'	Tom Hotz - Butters Realty (954) 312-2415	<a href="mailto:tom@butters.com">tom@butters.com</a>
		712 - 734 S. Military Trl.	Deerfield Beach	I	16,008	16,008	24'	Tom Hotz - Butters Realty (954) 312-2415	<a href="mailto:tom@butters.com">tom@butters.com</a>
		736 - 774 S. Military Trl.	Deerfield Beach	I	12,991	12,991	24'	Tom Hotz - Butters Realty (954) 312-2415	<a href="mailto:tom@butters.com">tom@butters.com</a>
		776 - 858 S. Military Trl.	Deerfield Beach	I/O	18,098	550	16'	Tom Hotz - Butters Realty (954) 312-2415	<a href="mailto:tom@butters.com">tom@butters.com</a>
		5555 Anglers Ave	Hollywood	O	18,583	931	16'	David Wigoda - Jones Lang Lasalle (954) 829-3737	<a href="mailto:david.wigoda@am.jll.com">david.wigoda@am.jll.com</a>
		3700 N. 29th Ave	Hollywood	I	14,850	3,100	22'	David Wigoda - Jones Lang Lasalle (954) 829-3737	<a href="mailto:david.wigoda@am.jll.com">david.wigoda@am.jll.com</a>
		3601-3613 N. 29th Ave	Hollywood	I	9,150	9,150	24'	David Wigoda - Jones Lang Lasalle (954) 829-3737	<a href="mailto:david.wigoda@am.jll.com">david.wigoda@am.jll.com</a>
		3850 N. 29th Ter	Hollywood	I	24,480	24,480	23'	David Wigoda - Jones Lang Lasalle (954) 829-3737	<a href="mailto:david.wigoda@am.jll.com">david.wigoda@am.jll.com</a>
		1951-1991 Tigertail Blvd	Hollywood	I	19,600	5,600	22'	David Wigoda - Jones Lang Lasalle (954) 829-3737	<a href="mailto:david.wigoda@am.jll.com">david.wigoda@am.jll.com</a>
		5553 Anglers Ave (Bldg 1)	Hollywood	I	32,000	32,000	21'	David Wigoda - Jones Lang Lasalle (954) 829-3737	<a href="mailto:david.wigoda@am.jll.com">david.wigoda@am.jll.com</a>
		5553 Anglers Ave (Bldg 4)	Hollywood	I	32,000	5,440	21'	David Wigoda - Jones Lang Lasalle (954) 829-3737	<a href="mailto:david.wigoda@am.jll.com">david.wigoda@am.jll.com</a>
645 NW Enterprise Dr.	Port St. Lucie	I	21,600	2,400	18'	Derrick Christenson - Christenson Commercial RE (772) 419-5076	<a href="mailto:derricksoldit@aol.com">derricksoldit@aol.com</a>		
651 NW Enterprise Dr.	Port St. Lucie	I	13,824	1,536	18'	Derrick Christenson - Christenson Commercial RE (772) 419-5076	<a href="mailto:derricksoldit@aol.com">derricksoldit@aol.com</a>		
7655 Enterprise Dr.	Riviera Beach	I	20,386	1,592	18'	Christopher Thomson - Cushman & Wakefield (561) 227-2020	<a href="mailto:christopher.thomson@cushwake.com">christopher.thomson@cushwake.com</a>		
7656 Byron Dr.	Riviera Beach	I	22,849	1,592	18'	Christopher Thomson - Cushman & Wakefield (561) 227-2020	<a href="mailto:christopher.thomson@cushwake.com">christopher.thomson@cushwake.com</a>		

State	Market	Address	City	Industrial/ Office/ Cold Storage	Availabilities (SF)		Clear Height	Listing Broker Contact	Broker Email
					Total	Minimum			
FL	Southeast Florida	7540 Byron Dr.	Riviera Beach	I	104,640	104,640	32'	Christopher Thomson - Cushman & Wakefield (561) 227-2020	<a href="mailto:christopher.thomson@cushwake.com">christopher.thomson@cushwake.com</a>
		9439 W. Commercial Blvd.	Tamarac	I	84,100	84,100	35'	Tom O'Loughlin - CBRE (954) 356-0468	<a href="mailto:tom.oloughlin@cbre.com">tom.oloughlin@cbre.com</a>
		1904 NW 97th Ave.	Doral	I	102,808	43,680	22'	Brian Smith - Cushman & Wakefield (305) 533-2892	<a href="mailto:brian.smith@cushwake.com">brian.smith@cushwake.com</a>
		2000 NW 97th Ave.	Doral	I	25,200	25,200	24'	Brian Smith - Cushman & Wakefield (305) 533-2892	<a href="mailto:brian.smith@cushwake.com">brian.smith@cushwake.com</a>
		2100 NW 97th Ave.	Doral	I	28,609	16,460	24'	Brian Smith - Cushman & Wakefield (305) 533-2892	<a href="mailto:brian.smith@cushwake.com">brian.smith@cushwake.com</a>
		Beacon @ 97th Ave (Land/BTS)	Doral	I	55,000	55,000	30'	Brian Smith - Cushman & Wakefield (305) 533-2892	<a href="mailto:brian.smith@cushwake.com">brian.smith@cushwake.com</a>
		Miami Int'l Distribution Center (Land/BTS)	Doral	I	335,741	151,100	36'	Jose Juncadella - Fairchild Partners (305) 668-0620	<a href="mailto:jjuncadella@fairchildpartners.com">jjuncadella@fairchildpartners.com</a>
		Miami Int'l Distribution Center (Land/BTS)	Doral	I	94,000	94,000	36'	Jose Juncadella - Fairchild Partners (305) 668-0620	<a href="mailto:jjuncadella@fairchildpartners.com">jjuncadella@fairchildpartners.com</a>
		Seneca North Industrial Park (Land/BTS)	Pembroke Pines	I	36,300	36,300	30'	Rick Etner - Cushman & Wakefield (954) 771-0800	<a href="mailto:rick.etner@cushwake.com">rick.etner@cushwake.com</a>
FL	Tampa	4023 Tampa Rd.	Oldsmar	I/O	20,064	9,564	20'	Alan Feldshue - Colliers Arnold (727) 442-7296	<a href="mailto:alan.feldshue@colliers.com">alan.feldshue@colliers.com</a>
		4025 Tampa Rd.	Oldsmar	I/O	19,638	750	20'	Alan Feldshue - Colliers Arnold (727) 442-7296	<a href="mailto:alan.feldshue@colliers.com">alan.feldshue@colliers.com</a>
		4027 Tampa Rd.	Oldsmar	I/O	32,000	11,500	22'	Al Corr - KTR Capital Partners (484) 530-1821	<a href="mailto:acorr@ktrcapital.com">acorr@ktrcapital.com</a>
		4029 Tampa Rd. (Sublet)	Oldsmar	I	94,000	18,000	22'	Al Corr - KTR Capital Partners (484) 530-1821	<a href="mailto:acorr@ktrcapital.com">acorr@ktrcapital.com</a>
		4035 Tampa Rd.	Oldsmar	O	17,725	7,225	n/a	Alan Feldshue - Colliers Arnold (727) 442-7296	<a href="mailto:alan.feldshue@colliers.com">alan.feldshue@colliers.com</a>
FL	Orlando	38 Skyline Dr.	Lake Mary	I	60,500	25,000	32'	Bo Bradford - Southern Commercial (321) 281-8502	<a href="mailto:bbradford@southerncommercialre.com">bbradford@southerncommercialre.com</a>
		7000 Kingspointe Pkwy.	Orlando	I	42,000	42,000	30'	Bo Bradford - Southern Commercial (321) 281-8502	<a href="mailto:bbradford@southerncommercialre.com">bbradford@southerncommercialre.com</a>
FL	Jacksonville	6595 Pritchard Rd.	Jacksonville	I	44,732	22,317	24'	Bobby Gatling - Grubb & Ellis / Phoenix Realty (904) 399-5222	<a href="mailto:bgatling@phoenixrealty.net">bgatling@phoenixrealty.net</a>
GA	Atlanta	1500 Distribution Ct.	Lithia Springs	I	89,337	20,000	24'	Bob Burdell - NAI Brannen Goddard (404) 812-4065	<a href="mailto:bburdell@naibg.com">bburdell@naibg.com</a>
		1575 Distribution Ct.	Lithia Springs	I	196,033	65,000	26'	Bob Burdell - NAI Brannen Goddard (404) 812-4065	<a href="mailto:bburdell@naibg.com">bburdell@naibg.com</a>
		660 Campbell Ct.	Lithia Springs	I	224,000	224,000	24'-28'	Chip Craighill - Cushman and Wakefield (404)-853-5875	<a href="mailto:chip.craighill@cushwake.com">chip.craighill@cushwake.com</a>
		1650 Horizon	Buford	I	60,960	20,480	28'	Nathan Pramik - Resource Real Estate Partners (770) 436-4553	<a href="mailto:npramik@resourcere.com">npramik@resourcere.com</a>
		200 S Mitchell Court	Addison	I	152,200	57,000	21'-9"	Jeff Fischer - NAI Hiffman (630) 317 - 0726	<a href="mailto:jfischer@hiffman.com">jfischer@hiffman.com</a>
IL	Chicago	5619 W. 115th St.	Alsip	I	349,889	51,384	28'	Larry Johnson - CB Richard Ellis (630) 573 - 7099	<a href="mailto:larry.johnson@cbre.com">larry.johnson@cbre.com</a>
		3557 Butterfield Rd.	Aurora	I	30,000	30,000	30'	Brian Kling - Colliers International (847) 698 - 8223	<a href="mailto:brian.kling@colliers.com">brian.kling@colliers.com</a>
		3565 Butterfield Rd.	Aurora	I	117,858	20,000	30'	Brian Kling - Colliers International (847) 698 - 8223	<a href="mailto:brian.kling@colliers.com">brian.kling@colliers.com</a>
		7447 Central Ave.	Bedford Park	I	62,500	62,500	21'	Steve Connolly - NAI Hiffman (630) 639-0642	<a href="mailto:sconnolly@hiffman.com">sconnolly@hiffman.com</a>
		513 Express Center Dr	Chicago	I	138,000	69,000	24'	Matt Mulvihill - CBRE (847) 706-4964	<a href="mailto:matt.mulvihill@cbre.com">matt.mulvihill@cbre.com</a>
		3100-3250 S. Central Ave.	Cicero	I	220,685	10,134	14'-22'	Tom Condon - Colliers International (847) 698-8212	<a href="mailto:tcondon@colliers.com">tcondon@colliers.com</a>
		200 E. Oakton St.	Des Plaines	I	80,480	80,480	18'	John Suerth - CBRE (847) 706-4929	<a href="mailto:john.suerth@cbre.com">john.suerth@cbre.com</a>
		105 E. Oakton St.	Des Plaines	I	180,020	80,820	23'	Matthew Stauber - Colliers International (847) 698-8236	<a href="mailto:matthew.stauber@colliers.com">matthew.stauber@colliers.com</a>
		801 Chase Ave.	Elk Grove Village	I	6,383	6,383	17'	Rick Daly - Darwin Realty (630) 782-9520	<a href="mailto:rdaly@darwinrealty.com">rdaly@darwinrealty.com</a>
		2501 Lunt Ave.	Elk Grove Village	I	154,776	154,776	24'	Matthew Stauber - Colliers International (847) 698-8236	<a href="mailto:matthew.stauber@colliers.com">matthew.stauber@colliers.com</a>
		3710 N. River Rd.	Franklin Park	I	108,773	20,000	30'	Matt Mulvihill - CBRE (847) 706-4964	<a href="mailto:matt.mulvihill@cbre.com">matt.mulvihill@cbre.com</a>
		10800-10900 W. Belmont Ave.	Franklin Park	I	66,417	66,417	16'-24'	Larry Goldwasser - Cushman & Wakefield (312) 470-2323	<a href="mailto:larry.goldwasser@cushwake.com">larry.goldwasser@cushwake.com</a>
		240 Windy Point Dr.	Glendale Heights	I	35,981	35,981	30'	Britt Casey - Cushman & Wakefield (847)518-3280	<a href="mailto:Britt.Casey@cushwake.com">Britt.Casey@cushwake.com</a>
		1820 Northwestern Ave.	Gurnee	I	24,000	24,000	22'	Robin Stolberg Jones Lang LaSalle (312) 228-3218	<a href="mailto:robin.stolberg@arn.jll.com">robin.stolberg@arn.jll.com</a>
		1400-1456 Norwood Dr	Itasca	I	74,158	14,080	16'	Jeff Janda - Lee & Associates of Illinois (773) 355-3015	<a href="mailto:jjanda@lee-associates.com">jjanda@lee-associates.com</a>
		2407 - 2457 W. North Avenue	Melrose Park	I	205,998	49,763	30"	Marty Edmondson - KTR Capital Partners (847) 737 - 4842	<a href="mailto:medmondson@ktrcapital.com">medmondson@ktrcapital.com</a>
		6100 W. Howard St.	Niles	I	81,390	81,390	23'	Chris Volkert - Colliers International (847) 698-8237	<a href="mailto:chris.volkert@colliers.com">chris.volkert@colliers.com</a>
21399 Torrence Ave.	Sauk Village	I	108,550	108,550	32'	Jeff Janda - Lee & Associates of Illinois (773) 355-3015	<a href="mailto:jjanda@lee-associates.com">jjanda@lee-associates.com</a>		
3701-3749 N. 25th Ave.	Schiller Park	I	12,978	5,618	16'	Tom Rodeno - Colliers International (847) 698-8231	<a href="mailto:tom.rodeno@colliers.com">tom.rodeno@colliers.com</a>		
10524 N. United Pkwy	Schiller Park	I	19,500	19,500	16'	Larry Goldwasser - Cushman & Wakefield (312) 470-2323	<a href="mailto:larry.goldwasser@cushwake.com">larry.goldwasser@cushwake.com</a>		
4310 Transworld Ave.	Schiller Park	I	23,000	23,000	18'	Larry Goldwasser - Cushman & Wakefield (312) 470-2323	<a href="mailto:larry.goldwasser@cushwake.com">larry.goldwasser@cushwake.com</a>		

State	Market	Address	City	Industrial/ Office/ Cold Storage	Availabilities (SF)		Clear Height	Listing Broker Contact	Broker Email
					Total	Minimum			
IL	Chicago	4350 N. United Pkwy.	Schiller Park	I	23,270	23,270	16'	Larry Goldwasser - Cushman & Wakefield (312) 470-2323	<a href="mailto:larry.goldwasser@cushwake.com">larry.goldwasser@cushwake.com</a>
		4205-4321 N. United Pkwy.	Schiller Park	I	5,000	5,000	16'	Larry Goldwasser - Cushman & Wakefield (312) 470-2323	<a href="mailto:larry.goldwasser@cushwake.com">larry.goldwasser@cushwake.com</a>
		10501 - 10505 Delta Pkwy.	Schiller Park	I	35,860	16,481	16'	Larry Goldwasser - Cushman & Wakefield (312) 470-2323	<a href="mailto:larry.goldwasser@cushwake.com">larry.goldwasser@cushwake.com</a>
		10509-10521 N. United Pkwy.	Schiller Park	I	40,000	8,000	16'	Larry Goldwasser - Cushman & Wakefield (312) 470-2323	<a href="mailto:larry.goldwasser@cushwake.com">larry.goldwasser@cushwake.com</a>
		4250 - 4306 N. United Pkwy.	Schiller Park	I	108,040	27,010	21'	Larry Goldwasser - Cushman & Wakefield (312) 470-2323	<a href="mailto:larry.goldwasser@cushwake.com">larry.goldwasser@cushwake.com</a>
		1601 Atlantic Dr.	West Chicago	I	6,491	3,233	18'	Adam Johnson- NAI Hiffman (630) 317-0729	<a href="mailto:ajohnson@hiffman.com">ajohnson@hiffman.com</a>
		712 N. Central Ave.	Wood Dale	I	30,115	30,115	22'	Jeff Fischer - NAI Hiffman (630) 317 - 0726	<a href="mailto:jfischer@hiffman.com">jfischer@hiffman.com</a>
		KTR - Crossroads DuPage (Land/BTS)	West Chicago	I	210,000	30,600	30'	Kirk Armour - CB Richard Ellis (847) 706 - 4030	<a href="mailto:kirk.armour@cbre.com">kirk.armour@cbre.com</a>
IN	Indianapolis	6887 West 350 N	Greenfield	I	135,000	135,000	32'	Steve A. Schwegman - Jones Lang LaSalle (317) 810-7185	<a href="mailto:steve.schwegman@am.jll.com">steve.schwegman@am.jll.com</a>
KY	Louisville	7240 Global Dr.	Louisville	I	82,950	82,950	32'	Kevin Grove - CBRE (502) 412-7615	<a href="mailto:kgrove@cbrelouisville.com">kgrove@cbrelouisville.com</a>
		300 Omicron Ct.	Louisville	I	140,548	140,548	36'	Kevin Grove - CBRE (502) 412-7615	<a href="mailto:kgrove@cbrelouisville.com">kgrove@cbrelouisville.com</a>
NJ	New Jersey	600 Meadowlands Pkwy.	Secaucus	I	15,043	2,400	24'	Brian Scheuer - Chaus Realty (201) 288-8818	<a href="mailto:bscheuerchausr@aol.com">bscheuerchausr@aol.com</a>
		600 Meadowlands Pkwy.	Secaucus	O	32,633	1,360	n/a	Brian Scheuer - Chaus Realty (201) 288-8818	<a href="mailto:bscheuerchausr@aol.com">bscheuerchausr@aol.com</a>
		3001 Woodbridge Ave.	Edison	I	393,000	86,000	27'	Adam Citron - Jones Lang LaSalle (732) 590-4174	<a href="mailto:adam.citron@am.jll.com">adam.citron@am.jll.com</a>
		3025 Woodbridge Ave.	Edison	I	62,208	62,208	36'	Adam Citron - Jones Lang LaSalle (732) 590-4174	<a href="mailto:adam.citron@am.jll.com">adam.citron@am.jll.com</a>
NV	Las Vegas	6280 S. Pecos Rd	Las Vegas	I/O	3,160	3,160	16'-30'	Spencer Pinter - Colliers (702) 836-3776	<a href="mailto:spinter@lvcolliers.com">spinter@lvcolliers.com</a>
		6290 S. Pecos Rd	Las Vegas	I/O	6,960	6,960	16'-30'	Spencer Pinter - Colliers (702) 836-3776	<a href="mailto:spinter@lvcolliers.com">spinter@lvcolliers.com</a>
		3550 E. Post Rd.	Las Vegas	I/O	10,974	4,012	16'-30'	Spencer Pinter - Colliers (702) 836-3776	<a href="mailto:spinter@lvcolliers.com">spinter@lvcolliers.com</a>
		3585 E. Patrick Ln.	Las Vegas	I/O	17,800	4,385	16'-30'	Spencer Pinter - Colliers (702) 836-3776	<a href="mailto:spinter@lvcolliers.com">spinter@lvcolliers.com</a>
		3595 E. Patrick Ln.	Las Vegas	I/O	48,514	5,267	16'-30'	Spencer Pinter - Colliers (702) 836-3776	<a href="mailto:spinter@lvcolliers.com">spinter@lvcolliers.com</a>
		6275 S. Pearl St.	Las Vegas	I/O	44,306	11,000	16'-30'	Spencer Pinter - Colliers (702) 836-3776	<a href="mailto:spinter@lvcolliers.com">spinter@lvcolliers.com</a>
		6295 S. Pearl St.	Las Vegas	I/O	50,956	4,800	16'-30'	Spencer Pinter - Colliers (702) 836-3776	<a href="mailto:spinter@lvcolliers.com">spinter@lvcolliers.com</a>
		3655 E. Patrick Ln.	Las Vegas	I/O	27,015	6,599	16'-30'	Spencer Pinter - Colliers (702) 836-3776	<a href="mailto:spinter@lvcolliers.com">spinter@lvcolliers.com</a>
		6180 S. Pearl St.	Las Vegas	I/O	86,870	21,600	16'-30'	Spencer Pinter - Colliers (702) 836-3776	<a href="mailto:spinter@lvcolliers.com">spinter@lvcolliers.com</a>
		3650 E. Post Rd.	Las Vegas	I/O	27,981	11,661	16'-30'	Spencer Pinter - Colliers (702) 836-3776	<a href="mailto:spinter@lvcolliers.com">spinter@lvcolliers.com</a>
		6175 S. Sandhill Rd.	Las Vegas	I/O	12,600	12,600	16'-30'	Spencer Pinter - Colliers (702) 836-3776	<a href="mailto:spinter@lvcolliers.com">spinter@lvcolliers.com</a>
		6155 S. Sandhill Rd.	Las Vegas	I/O	26,228	6,050	16'-30'	Spencer Pinter - Colliers (702) 836-3776	<a href="mailto:spinter@lvcolliers.com">spinter@lvcolliers.com</a>
		6275 S. Sandhill Rd.	Las Vegas	I/O	15,000	15,000	16'-30'	Spencer Pinter - Colliers (702) 836-3776	<a href="mailto:spinter@lvcolliers.com">spinter@lvcolliers.com</a>
		6255 S. Sandhill Rd.	Las Vegas	I/O	4,800	4,800	16'-30'	Spencer Pinter - Colliers (702) 836-3776	<a href="mailto:spinter@lvcolliers.com">spinter@lvcolliers.com</a>
		7350 Dean Martin Dr.	Las Vegas	I/O	6,596	6,596	20'-24'	Jeremy Green - CBRE (702) 369-4883	<a href="mailto:jeremy.green@cbre.com">jeremy.green@cbre.com</a>
		7370 Dean Martin Dr.	Las Vegas	I/O	21,629	21,629	20'-24'	Jeremy Green - CBRE (702) 369-4883	<a href="mailto:jeremy.green@cbre.com">jeremy.green@cbre.com</a>
7440 Dean Martin Dr.	Las Vegas	I/O	99,869	21,350	20'-24'	Jeremy Green - CBRE (702) 369-4883	<a href="mailto:jeremy.green@cbre.com">jeremy.green@cbre.com</a>		
5220 Cameron St.	Las Vegas	I/O	54,175	54,175	24'	Mike Hillis & Susan Borst - CW (702) 688-6915	<a href="mailto:sborst@comre.com">sborst@comre.com</a>		
6445 Montessori St.	Las Vegas	I/O	71,678	71,678	30'	Mike Hillis & Susan Borst - CW (702) 688-6915	<a href="mailto:sborst@comre.com">sborst@comre.com</a>		
NV	Reno	Eagle Valley Industrial Center (Land/BTS)	McCarran	I	566,875	275,000	32'-36'	Eric Bennett - CBRE (775) 823-6963	<a href="mailto:eric.bennett@cbre.com">eric.bennett@cbre.com</a>
OH	Columbus	5650 Greenpoint Dr. North	Groveport	I	120,000	60,000	32'	Michael Mullady - CBRE (614) 430-5030	<a href="mailto:michael.mullady@cbre.com">michael.mullady@cbre.com</a>
		5820 Opus Dr.	Groveport	O	181,190	90,595	36'	Jeff Lyons - CBRE (614) 430-5012	<a href="mailto:jeff.lyons@cbre.com">jeff.lyons@cbre.com</a>
		6766 Pontius Road	Groveport	I	160,000	160,000	32' - 37'	Michael Mullady - CBRE (614) 430-5030	<a href="mailto:michael.mullady@cbre.com">michael.mullady@cbre.com</a>
PA	Harrisburg	3700 Industrial Rd.	Harrisburg	I	209,110	209,110	30'	Joe McDermott - CBRE (610) 251-5107	<a href="mailto:joe.mcdermott@cbre.com">joe.mcdermott@cbre.com</a>
		3700 Industrial Rd.	Harrisburg	C	178,479	82,682	30'	Joe McDermott - CBRE (610) 251-5107	<a href="mailto:joe.mcdermott@cbre.com">joe.mcdermott@cbre.com</a>
		3700 Industrial Rd.	Harrisburg	Truck Maint.	15,100	15,100	20'	Joe McDermott - CBRE (610) 251-5107	<a href="mailto:joe.mcdermott@cbre.com">joe.mcdermott@cbre.com</a>
	Carlisle	950 Centerville Road	Newville	I	570,000	570,000	32'	Michael Hess - CBRE (717) 540-2705	<a href="mailto:michael.hess@cbre.com">michael.hess@cbre.com</a>
TN	Nashville	104 Challenger Rd.	Portland	I	300,000	60,000	30'	Michael Reid - Binswanger (404) 307-6900	<a href="mailto:mreid@binswanger.com">mreid@binswanger.com</a>

Current Availabilities as of September 2012

State	Market	Address	City	Industrial/ Office/ Cold Storage	Availabilities (SF)		Clear Height	Listing Broker Contact	Broker Email
					Total	Minimum			
TX	Dallas	921 W. Bethel Rd., Bldg 300	Coppell	I	36,870	36,870	30'	Rick Medinis - NAI Robert Lynn (214) 256-7116	<a href="mailto:rmedinis@robertlynn.com">rmedinis@robertlynn.com</a>
		777 Freeport Pkwy	Coppell	O	43,132	18,132	n/a	Rick Medinis - NAI Robert Lynn (214) 256-7116	<a href="mailto:rmedinis@robertlynn.com">rmedinis@robertlynn.com</a>
		14900 Frye Rd.	Ft. Worth	I	494,990	146,790	32'	Cannon Green - Stream Realty Partners (214) 560-5096	<a href="mailto:cgreen@streamrealty.com">cgreen@streamrealty.com</a>
		5401 N. Riverside Dr. (Sublet)	Ft. Worth	I	658,692	658,692	40'	Paul Whitman - JLL (214) 438-6280	<a href="mailto:paul.whitman@am.jll.com">paul.whitman@am.jll.com</a>
TX	Houston	14430-14440 JFK Blvd.	Houston	I/O	56,000	13,440	24'	Justin Robinson Stream Realty Partners (713) 300-0304	<a href="mailto:jrobinson@streamrealty.com">jrobinson@streamrealty.com</a>
		14430-14440 JFK Blvd.	Houston	I	11,200	11,200	24'	Justin Robinson Stream Realty Partners (713) 300-0304	<a href="mailto:jrobinson@streamrealty.com">jrobinson@streamrealty.com</a>
		9010 West Little York Rd	Houston	I	91,200	22,800	24'	Justin Robinson Stream Realty Partners (713) 300-0304	<a href="mailto:jrobinson@streamrealty.com">jrobinson@streamrealty.com</a>
WI	Wisconsin	11100 W. Silver Spring Rd.	Milwaukee	I	127,400	28,286	22' - 24'	Samuel Dickman Jr. - The Dickman Company (414) 271-6100	<a href="mailto:sam-jr@dickmanrealestate.com">sam-jr@dickmanrealestate.com</a>

**KTR Asset Management Contacts**

**Steve Butte - Partner - National**  
 sbutte@ktrcapital.com (484) 530-1843

**Steve Pron - Senior Vice President - Midwest**  
 spron@ktrcapital.com (484) 530-1851

**Brad Stitchberry - Vice President - Southeast FL**  
 bstitchberry@ktrcapital.com (954) 354-0290

**John Clowney - Vice President - GA, TX**  
 jclowney@ktrcapital.com (919) 900-8323

**Al Corr - Senior Vice President - PA, NJ, NV, CFL**  
 acorr@ktrcapital.com (484) 530-1821

**Bob Andrews - Senior Vice President - CA, WA, AZ**  
 bandrews@ktrcapital.com (213) 784-3656

**Kevin Apel - Vice President - Southern CA, AZ**  
 kapel@ktrcapital.com (213) 784-4429

**Renee Carroll - Asset Manager - NV**  
 rcarroll@ktrcapital.com (702) 605-6508

**Marty Edmondson - Vice President - IL, OH**  
 medmondson@ktrcapital.com (312) 588-3531

**Rob Turcott - Vice President - IL, WI**  
 rturcott@ktrcapital.com (312) 588-3530

FOR LEASE

# Westfork Industrial Park

65,000 - 196,033 RSF



1575 Distribution Courtt, Lithia Springs, GA 30122

## Features

- 65,000 - 196,033 SF Available
- 17.55 Acres
- Fenced Truck Court
- EPDM Room with R-15 Insulation
- M-1 Zoning
- Located in Master-planned Business Park Environment

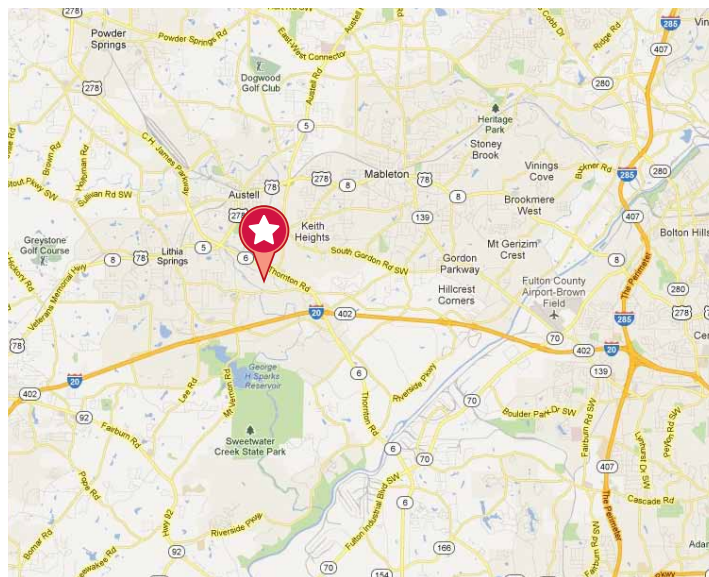

## Building Specs

**AVAILABLE SPACE**  
65,000 - 196,033 SF

**OFFICE SPACE**  
12,000 SF

**BUILDING DIMENSIONS**  
320' x 600'

**CLEAR HEIGHT**  
26' Minimum

**TRUCK DOORS**  
20 Dock-high, 1 Drive-In

**COLUMN SPACING**  
40' x 45'

**TRUCK COURT DEPTH**  
130'

**CONSTRUCTION DATE**  
1996

**AUTO PARKING**  
141 Spaces

**LIGHTING**  
T-5 Lighting with Motion Sensors

**SPRINKLER**  
ESFR



Commercial Real Estate Services, Worldwide.

404 812 4000 | fax 404 816 3939 | www.naibg.com  
Suite 1100 | 5555 Glenridge Connector | Atlanta GA 30342

Information is deemed from reliable sources. No warranty is made as to its accuracy.

**CHRIS MILLER**  
404 812 4084  
cmiller@naibg.com

**BOB BURDELL, CCIM, SIOR**  
404 812 4065  
bburdell@naibg.com

FOR LEASE

# Westfork Industrial Park

65,000 - 196,033

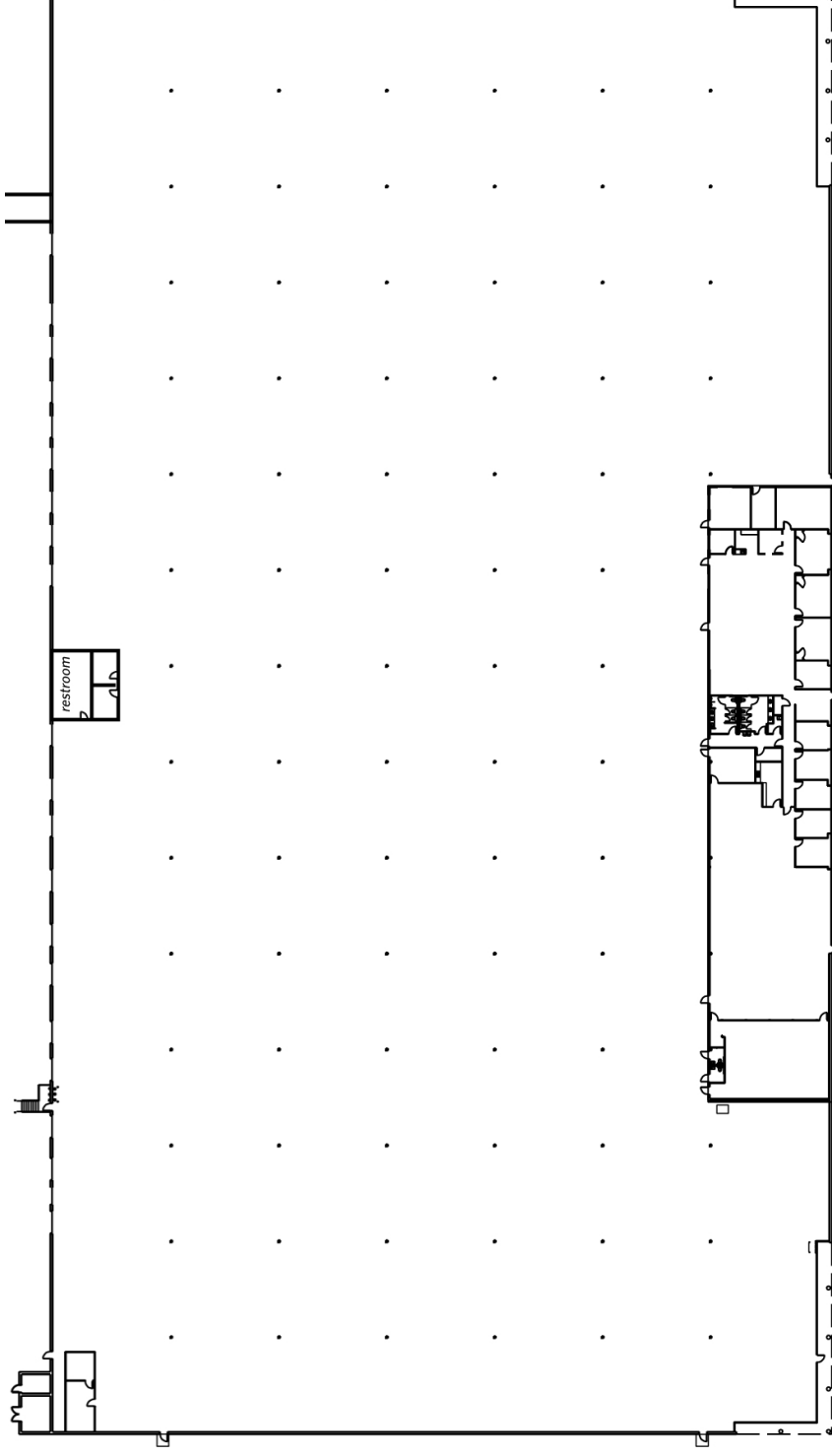

## Building Specs

**AVAILABLE SPACE**  
65,000 - 196,033 SF

**OFFICE SPACE**  
12,000 SF

**BUILDING DIMENSIONS**  
320' x 600'

**CLEAR HEIGHT**  
26' Minimum

**TRUCK DOORS**  
20 Dock-high, 1 Drive-In

**COLUMN SPACING**  
40' x 45'

**TRUCK COURT DEPTH**  
130'

**CONSTRUCTION DATE**  
1996

**AUTO PARKING**  
141 Spaces

**LIGHTING**  
T-5 Lighting with Motion Sensors

**SPRINKLER**  
ESFR



**CHRIS MILLER**  
404 812 4084  
cmiller@naibg.com

**NAI Brannen Goddard**  
Commercial Real Estate Services, Worldwide.  
404 812 4000 | fax 404 816 3939 | www.naibg.com  
Suite 1100 | 5555 Glenridge Connector | Atlanta GA 30342  
Information is deemed from reliable sources. No warranty is made as to its accuracy.

**BOB BURDELL, CCIM, SIOR**  
404 812 4065  
bburdell@naibg.com

FOR LEASE

# Westfork Industrial Park

20,000 - 89,337 RSF



1500 Distribution Courtt, Lithia Springs, GA 30122

## Features

20,000 - 89,337 SF Available

Located in Master-planned  
Business Park Environment

M-1 Zoning

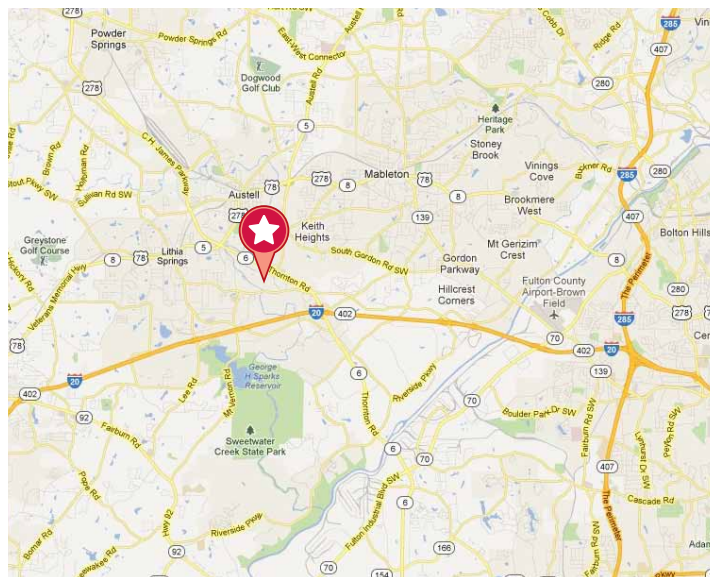

## Building Specs

**AVAILABLE SPACE**  
20,000 - 89,337 SF

**BUILDING DIMENSIONS**  
220' x 570'

**CLEAR HEIGHT**  
24' Minimum

**TRUCK DOORS**  
18 Dock-high, 1 Drive-In

**COLUMN SPACING**  
40' x 50'

**TRUCK COURT DEPTH**  
120'

**CONSTRUCTION DATE**  
1995

**AUTO PARKING**  
102 Spaces

**LIGHTING**  
T-5 Lighting with Motion  
Sensors

**SPRINKLER**  
ESFR



**NAI** Brannen Goddard

Commercial Real Estate Services, Worldwide.

404 812 4000 | fax 404 816 3939 | www.naibg.com

Suite 1100 | 5555 Glenridge Connector | Atlanta GA 30342

Information is deemed from reliable sources. No warranty is made as to its accuracy.

**CHRIS MILLER**

**404 812 4084**

cmiller@naibg.com

**BOB BURDELL, CCIM, SIOR**

**404 812 4065**

bburdell@naibg.com

FOR LEASE

# Westfork Industrial Park

20,000 - 89,337 RSF

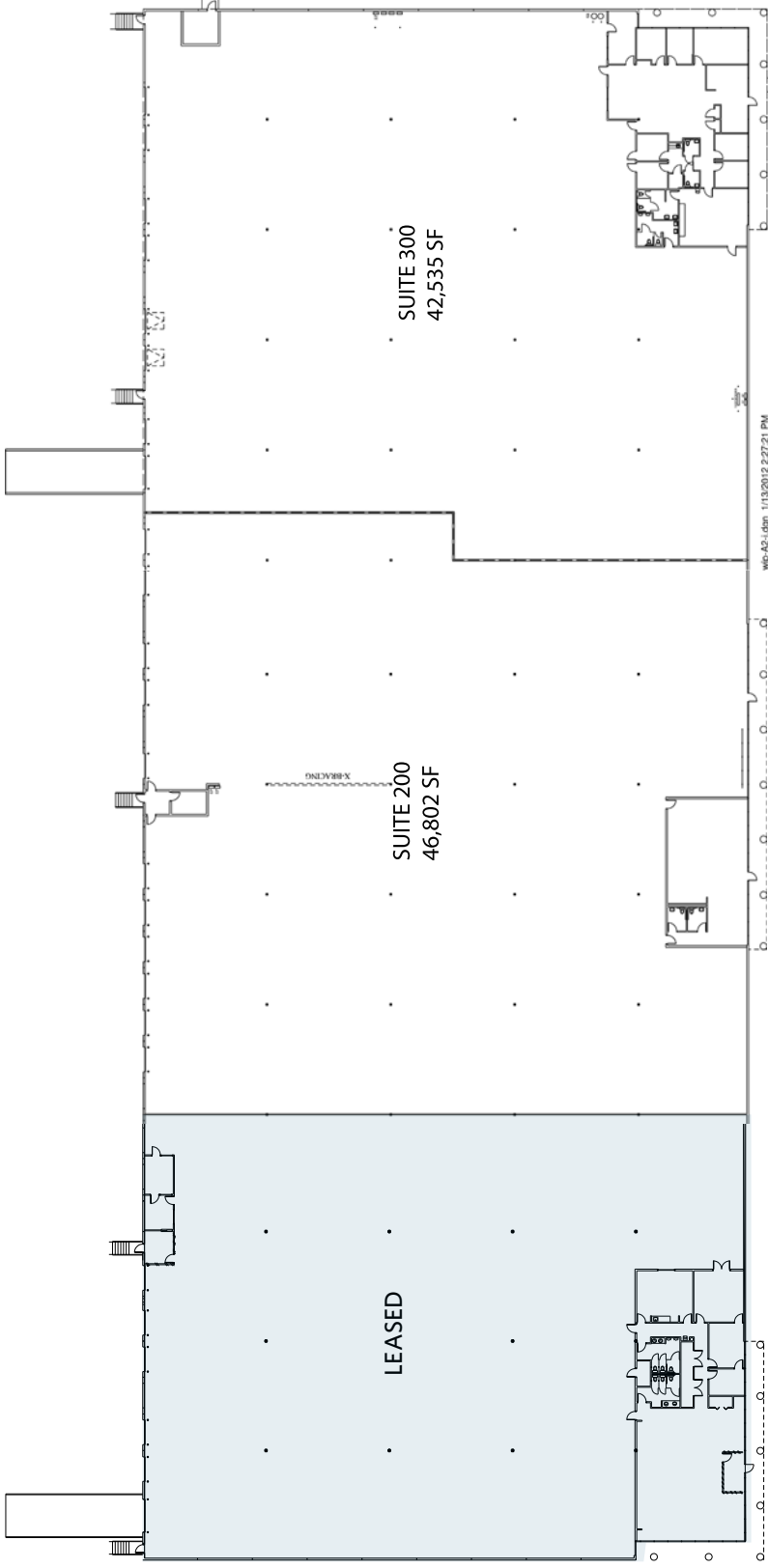

## Building Specs

**AVAILABLE SPACE**  
20,000 - 89,337 SF

**BUILDING DIMENSIONS**  
220' x 570'

**CLEAR HEIGHT**  
24' Minimum

**TRUCK DOORS**  
18 Dock-high, 1 Drive-In

**COLUMN SPACING**  
40' x 50'

**TRUCK COURT DEPTH**  
120'

**CONSTRUCTION DATE**  
1995

**AUTO PARKING**  
102 Spaces

**LIGHTING**  
T-5 Lighting with Motion Sensors

**SPRINKLER**  
ESFR



**CHRIS MILLER**  
404 812 4084  
cmiller@naibg.com

**BOB BURDELL, CCIM, SIOR**  
404 812 4065  
bburdell@naibg.com

**NAI Brannen Goddard**

Commercial Real Estate Services, Worldwide.

404 812 4000 | fax 404 816 3939 | www.naibg.com

Suite 1100 | 5555 Glenridge Connector | Atlanta GA 30342

Information is deemed from reliable sources. No warranty is made as to its accuracy.