

State	Market	Address	City	Industrial/ Office/ Cold Storage	Availabilities (SF)		Clear Height	Listing Broker Contact	Broker Email		
					Total	Minimum					
AZ	Southwest Phoenix	4901 W. Van Buren St.	Phoenix	I	5,780	5,780	18'	Marc Hertzberg - Jones Lang LaSalle (602) 648-9219	<a href="mailto:marc.hertzberg@amjll.com">marc.hertzberg@amjll.com</a>		
		4929 W. Van Buren St.	Phoenix	I	74,642	37,321	24'	Marc Hertzberg - Jones Lang LaSalle (602) 648-9219	<a href="mailto:marc.hertzberg@amjll.com">marc.hertzberg@amjll.com</a>		
		6111 W. Washington St. (Land/BTS)	Phoenix	I	273,000	114,000	32'-36'	John Werstler - CBRE (602) 735-5504	<a href="mailto:john.werstler@cbre.com">john.werstler@cbre.com</a>		
CA	Los Angeles	24760 S Main St.	Carson	I	231,008	231,008	30'	John Repstad - Binswanger (213) 892-8881	<a href="mailto:jrepstad@raginc.com">jrepstad@raginc.com</a>		
		2601 S. Malt Ave.	Commerce	I	180,473	180,473	20'-22'	Dave Hess - Cushman & Wakefield (213) 955-6412	<a href="mailto:dave.hess@cushwake.com">dave.hess@cushwake.com</a>		
		6100 Garfield Ave. (Land/BTS)	Commerce	I	620,000	152,000	36'	Zac Sakowski - JLL (213) 239-6239	<a href="mailto:zac.sakowski@amjll.com">zac.sakowski@amjll.com</a>		
		350 W. Manville St.	Compton	I	50,000	50,000	24'	Brad Levin - Daum Commercial (310) 538-6728	<a href="mailto:brad.levin@daumcommercial.com">brad.levin@daumcommercial.com</a>		
		675 W. Manville St.	Compton	I	123,456	123,456	22'	Rooney Daschbach - Cushman & Wakefield (562) 276-1431	<a href="mailto:rooney.daschbach@cushwake.com">rooney.daschbach@cushwake.com</a>		
		13169 Slover Ave.	Fontana	I	184,755	69,720	32'	Chuck Belden - Cushman & Wakefield (909) 942-4640	<a href="mailto:chuck.belden@cushwake.com">chuck.belden@cushwake.com</a>		
		13083 Slover Ave.	Fontana	I	43,802	43,802	32'	Chuck Belden - Cushman & Wakefield (909) 942-4640	<a href="mailto:chuck.belden@cushwake.com">chuck.belden@cushwake.com</a>		
		1990 S. Cucamonga Ave.	Ontario	I	416,713	416,713	30'	Len Santoro - CBRE (909) 418-2158	<a href="mailto:len.santoro@cbre.com">len.santoro@cbre.com</a>		
		4422 Airport Dr.	Ontario	I	62,835	62,835	24'	Len Santoro - CBRE (909) 418-2158	<a href="mailto:len.santoro@cbre.com">len.santoro@cbre.com</a>		
		1601 W. Mission Blvd.	Pomona	I	751,528	7,338	12'-20'	John Repstad - Binswanger (213) 892-8881	<a href="mailto:jrepstad@raginc.com">jrepstad@raginc.com</a>		
CA	Bay Area	9910 Nevada St. (Land/BTS)	Redlands	I	425,940	425,940	32'	Jeff Smith - Lee & Associates (909) 373-2909	<a href="mailto:jsmith@lee-assoc.com">jsmith@lee-assoc.com</a>		
		9425 Nevada St.	Redlands	I	606,000	187,673	32'	Chuck Belden - Cushman & Wakefield (909) 942-4640	<a href="mailto:chuck.belden@cushwake.com">chuck.belden@cushwake.com</a>		
		8024-8076 Central Ave.	Newark	I/O	36,999	7,801	20'	Joe Kelly - CBRE (408) 453-7474	<a href="mailto:joe.kelly@cbre.com">joe.kelly@cbre.com</a>		
		FL	Southeast Florida	1001 Broken Sound Pkwy.	Boca Raton	I/O	10,250	10,250	16'	Jeff Kelly - CBRE (561) 393-1621	<a href="mailto:jeffrey.kelly@cbre.com">jeffrey.kelly@cbre.com</a>
				1155 Broken Sound Pkwy.	Boca Raton	I/O	42,563	11,351	16'	Jeff Kelly - CBRE (561) 393-1621	<a href="mailto:jeffrey.kelly@cbre.com">jeffrey.kelly@cbre.com</a>
				1225 Broken Sound Pkwy.	Boca Raton	I/O	16,281	5,720	16'	Jeff Kelly - CBRE (561) 393-1621	<a href="mailto:jeffrey.kelly@cbre.com">jeffrey.kelly@cbre.com</a>
				1335 W. 53rd St.	Mangonia Park	I	27,265	7,500	24'	Robert Smith - CBRE (561) 393-1608	<a href="mailto:robert.c.smith@cbre.com">robert.c.smith@cbre.com</a>
				1395 NW 17th Ave.	Delray Beach	I/O	15,149	1,219	20'	Christopher Thomson - Cushman & Wakefield (561) 227-2020	<a href="mailto:christopher.thomson@cushwake.com">christopher.thomson@cushwake.com</a>
				430 S. Congress Ave.	Delray Beach	I	41,334	9,013	24'	Jeff Kelly - CBRE (561) 393-1621	<a href="mailto:jeffrey.kelly@cbre.com">jeffrey.kelly@cbre.com</a>
				251 International Pkwy. (Sublet)	Sunrise	I	178,791	178,791	40'	Brad Stitchberry - KTR Capital Partners (954) 421-0948	<a href="mailto:bstitchberry@ktrcapital.com">bstitchberry@ktrcapital.com</a>
602 - 668 S. Military Trl.	Deerfield Beach			I/O	22,967	1,843	16'	Tom Hotz - Butters Realty (954) 312-2415	<a href="mailto:tom@butters.com">tom@butters.com</a>		
674 - 692 S. Military Trl.	Deerfield Beach			I	24,613	7,200	18'	Tom Hotz - Butters Realty (954) 312-2415	<a href="mailto:tom@butters.com">tom@butters.com</a>		
700 - 710 S. Military Trl.	Deerfield Beach			I	18,111	18,111	18'	Tom Hotz - Butters Realty (954) 312-2415	<a href="mailto:tom@butters.com">tom@butters.com</a>		
712 - 734 S. Military Trl.	Deerfield Beach	I	24,526	8,518	24'	Tom Hotz - Butters Realty (954) 312-2415	<a href="mailto:tom@butters.com">tom@butters.com</a>				
736 - 774 S. Military Trl.	Deerfield Beach	I	15,325	15,325	24'	Tom Hotz - Butters Realty (954) 312-2415	<a href="mailto:tom@butters.com">tom@butters.com</a>				
776 - 858 S. Military Trl.	Deerfield Beach	I/O	27,994	550	16'	Tom Hotz - Butters Realty (954) 312-2415	<a href="mailto:tom@butters.com">tom@butters.com</a>				
5555 Anglers Ave	Hollywood	O	9,277	1,000	16'	David Wigoda - Jones Lang Lasalle (954) 829-3737	<a href="mailto:david.wigoda@amjll.com">david.wigoda@amjll.com</a>				
3601-3613 N. 29th Ave	Hollywood	I	9,150	9,150	24'	David Wigoda - Jones Lang Lasalle (954) 829-3737	<a href="mailto:david.wigoda@amjll.com">david.wigoda@amjll.com</a>				
3850 N. 29th Ter	Hollywood	I	24,480	24,480	23'	David Wigoda - Jones Lang Lasalle (954) 829-3737	<a href="mailto:david.wigoda@amjll.com">david.wigoda@amjll.com</a>				
1901-1949 Tigertail Blvd	Hollywood	I	7,000	7,000	22'	David Wigoda - Jones Lang Lasalle (954) 829-3737	<a href="mailto:david.wigoda@amjll.com">david.wigoda@amjll.com</a>				
5553 Anglers Ave (Bldg 4)	Hollywood	I	32,000	5,440	21'	David Wigoda - Jones Lang Lasalle (954) 829-3737	<a href="mailto:david.wigoda@amjll.com">david.wigoda@amjll.com</a>				
645 NW Enterprise Dr.	Port St. Lucie	I	19,200	2,400	18'	Derrick Christenson - Christenson Commercial RE (772) 419-5076	<a href="mailto:derricksoldit@aol.com">derricksoldit@aol.com</a>				
651 NW Enterprise Dr.	Port St. Lucie	I	16,896	1,536	18'	Derrick Christenson - Christenson Commercial RE (772) 419-5076	<a href="mailto:derricksoldit@aol.com">derricksoldit@aol.com</a>				
7655 Enterprise Dr.	Riviera Beach	I	7,650	1,600	18'	Christopher Thomson - Cushman & Wakefield (561) 227-2020	<a href="mailto:christopher.thomson@cushwake.com">christopher.thomson@cushwake.com</a>				
7656 Byron Dr.	Riviera Beach	I	21,715	1,592	18'	Christopher Thomson - Cushman & Wakefield (561) 227-2020	<a href="mailto:christopher.thomson@cushwake.com">christopher.thomson@cushwake.com</a>				
7540 Byron Dr.	Riviera Beach	I	104,640	104,640	32'	Christopher Thomson - Cushman & Wakefield (561) 227-2020	<a href="mailto:christopher.thomson@cushwake.com">christopher.thomson@cushwake.com</a>				
9439 W. Commercial Blvd.	Tamarac	I	84,100	84,100	35'	Tom O'Loughlin - CBRE (954) 356-0468	<a href="mailto:tom.oloughlin@cbre.com">tom.oloughlin@cbre.com</a>				
1904 NW 97th Ave.	Doral	I	102,899	43,680	22'	Brian Smith - Cushman & Wakefield (305) 533-2892	<a href="mailto:brian.smith@cushwake.com">brian.smith@cushwake.com</a>				

State	Market	Address	City	Industrial/ Office/ Cold Storage	Availabilities (SF)		Clear Height	Listing Broker Contact	Broker Email
					Total	Minimum			
FL	Southeast Florida	Beacon @ 97th Ave (Land/BTS)	Doral	I	55,000	55,000	30'	Brian Smith - Cushman & Wakefield (305) 533-2892	<a href="mailto:brian.smith@cushwake.com">brian.smith@cushwake.com</a>
		Miami Int'l Distribution Center (Land/BTS)	Doral	I	335,841	151,100	36'	Jose Juncadella - Fairchild Partners (305) 668-0620	<a href="mailto:jjuncadella@fairchildpartners.com">jjuncadella@fairchildpartners.com</a>
		Miami Int'l Distribution Center (Land/BTS)	Doral	I	94,000	94,000	36'	Jose Juncadella - Fairchild Partners (305) 668-0620	<a href="mailto:jjuncadella@fairchildpartners.com">jjuncadella@fairchildpartners.com</a>
		Seneca North Industrial Park (Land/BTS)	Pembroke Pines	I	36,300	36,300	30'	Rick Etner - Cushman & Wakefield (954) 771-0800	<a href="mailto:rick.etner@cushwake.com">rick.etner@cushwake.com</a>
FL	Tampa	4023 Tampa Rd.	Oldsmar	I/O	30,564	9,564	20'	Alan Feldshue - Colliers Arnold (727) 442-7296	<a href="mailto:alan.feldshue@colliers.com">alan.feldshue@colliers.com</a>
		4025 Tampa Rd.	Oldsmar	I/O	19,638	750	20'	Alan Feldshue - Colliers Arnold (727) 442-7296	<a href="mailto:alan.feldshue@colliers.com">alan.feldshue@colliers.com</a>
		4027 Tampa Rd. (Sublet)	Oldsmar	I/O	32,000	11,500	22'	John Dunphy - Jones Lang LaSalle (813) 387-1312	<a href="mailto:JohnC.Dunphy@am.jll.com">JohnC.Dunphy@am.jll.com</a>
		4029 Tampa Rd. (Sublet)	Oldsmar	I	94,000	18,000	22'	John Dunphy - Jones Lang LaSalle (813) 387-1312	<a href="mailto:JohnC.Dunphy@am.jll.com">JohnC.Dunphy@am.jll.com</a>
FL	Orlando	38 Skyline Dr.	Lake Mary	I	60,500	25,000	32'	Bo Bradford - Southern Commercial (321) 281-8502	<a href="mailto:bbradford@southerncommercialre.com">bbradford@southerncommercialre.com</a>
		7000 Kingspointe Pkwy.	Orlando	I	42,000	42,000	30'	Bo Bradford - Southern Commercial (321) 281-8502	<a href="mailto:bbradford@southerncommercialre.com">bbradford@southerncommercialre.com</a>
GA	Atlanta	1500 Distribution Ct.	Lithia Springs	I	35,533	35,533	24'	Chris Miller - NAI Brannen Goddard (404) 812-4084	<a href="mailto:cmiller@naibg.com">cmiller@naibg.com</a>
		1575 Distribution Ct.	Lithia Springs	I	85,000	85,000	26'	Chris Miller - NAI Brannen Goddard (404) 812-4084	<a href="mailto:cmiller@naibg.com">cmiller@naibg.com</a>
		1650 Horizon Pky	Buford	I	116,440	20,480	28'	Mark Hawks - CBRE (404) 504-5978	<a href="mailto:mark.hawks@cbre.com">mark.hawks@cbre.com</a>
IL	Chicago	200 S Mitchell Court	Addison	I	152,200	57,000	22'	Jeff Fischer - NAI Hiffman (630) 317 - 0726	<a href="mailto:jfischer@hiffman.com">jfischer@hiffman.com</a>
		5619 W. 115th St.	Alsip	I	170,563	170,563	28'	Larry Johnson - CB Richard Ellis (630) 573 - 7099	<a href="mailto:larry.johnson@cbre.com">larry.johnson@cbre.com</a>
		3557 Butterfield Rd.	Aurora	I	88,114	30,000	30'	Brian Kling - Colliers International (847) 698 - 8223	<a href="mailto:brian.kling@colliers.com">brian.kling@colliers.com</a>
		3565 Butterfield Rd.	Aurora	I	29,879	29,879	30'	Brian Kling - Colliers International (847) 698 - 8223	<a href="mailto:brian.kling@colliers.com">brian.kling@colliers.com</a>
		7447 Central Ave.	Bedford Park	I	62,500	62,500	21'	Steve Connolly - NAI Hiffman (630) 639-0642	<a href="mailto:sconnolly@hiffman.com">sconnolly@hiffman.com</a>
		595 Territorial Dr.	Bolingbrook	I	67,904	33,745	28'	Terry Grapenthin - Cawley Chicago (630) 810-1160	<a href="mailto:tgrape@cawleychicago.com">tgrape@cawleychicago.com</a>
		290 Gerzevske Lane	Carol Stream	I	45,240	45,240	24'	Justin Lerner - Newmark Knight Frank Epic (847) 588 - 5665	<a href="mailto:jlerner@newmarkkfe.com">jlerner@newmarkkfe.com</a>
		513 Express Center Dr	Chicago	I	138,000	69,000	24'	Matt Mulvihill - CBRE (847) 706-4964	<a href="mailto:matt.mulvihill@cbre.com">matt.mulvihill@cbre.com</a>
		3100-3250 S. Central Ave.	Cicero	I	220,685	10,134	14'-22'	Tom Condon - Colliers International (847) 698-8212	<a href="mailto:tcondon@colliers.com">tcondon@colliers.com</a>
		105 E. Oakton St.	Des Plaines	I	100,227	100,227	23'	Matthew Stauber - Colliers International (847) 698-8236	<a href="mailto:matthew.stauber@colliers.com">matthew.stauber@colliers.com</a>
		801 Chase Ave.	Elk Grove Village	I	6,383	6,383	17'	Rick Daly - Darwin Realty (630) 782-9520	<a href="mailto:rdaly@darwinrealty.com">rdaly@darwinrealty.com</a>
		1250 Arthur Avenue	Elk Grove Village	I	96,382	41,491	20'	Chris Nelson - Lee & Associates of Illinois (773) 355-3011	<a href="mailto:cnelson@lee-associates.com">cnelson@lee-associates.com</a>
		3710 N. River Rd.	Franklin Park	I	79,961	20,000	30'	Matt Mulvihill - CBRE (847) 706-4964	<a href="mailto:matt.mulvihill@cbre.com">matt.mulvihill@cbre.com</a>
		10800-10900 W. Belmont Ave.	Franklin Park	I	66,417	66,417	16'-24'	Larry Goldwasser - Cushman & Wakefield (312) 470-2323	<a href="mailto:larry.goldwasser@cushwake.com">larry.goldwasser@cushwake.com</a>
		240 Windy Point Dr.	Glendale Heights	I	36,617	36,617	30'	Britt Casey - Cushman & Wakefield (847) 518-3280	<a href="mailto:Britt_Casey@cushwake.com">Britt_Casey@cushwake.com</a>
		1100 Lakeside Dr.	Gurnee	I	39,364	39,364	18'	Keith Puritz - CBRE (847) 572-1410	<a href="mailto:keith.puritz@cbre.com">keith.puritz@cbre.com</a>
		1820 Northwestern Ave.	Gurnee	I	24,000	24,000	22'	Robin Stolberg Jones Lang LaSalle (312) 228-3218	<a href="mailto:robin.stolberg@am.jll.com">robin.stolberg@am.jll.com</a>
		1400-1456 Norwood Dr	Itasca	I	19,478	19,478	16'	Jeff Janda - Lee & Associates of Illinois (773) 355-3015	<a href="mailto:jjanda@lee-associates.com">jjanda@lee-associates.com</a>
		2407 - 2457 W. North Avenue	Melrose Park	I	205,998	49,763	30'	John Suerth - CBRE (847) 706-4929	<a href="mailto:john.suerth@cbre.com">john.suerth@cbre.com</a>
		3701-3749 N. 25th Ave.	Schiller Park	I	7,360	7,360	16'	Tom Rodeno - Colliers International (847) 698-8231	<a href="mailto:tom.rodeno@colliers.com">tom.rodeno@colliers.com</a>
10524 N. United Pkwy	Schiller Park	I	19,500	19,500	16'	Larry Goldwasser - Cushman & Wakefield (312) 470-2323	<a href="mailto:larry.goldwasser@cushwake.com">larry.goldwasser@cushwake.com</a>		
4136 N. United Pkwy.	Schiller Park	I	107,040	107,040	22'	Larry Goldwasser - Cushman & Wakefield (312) 470-2323	<a href="mailto:larry.goldwasser@cushwake.com">larry.goldwasser@cushwake.com</a>		
4210 Transworld	Schiller Park	I	16,200	16,200	16'	Larry Goldwasser - Cushman & Wakefield (312) 470-2323	<a href="mailto:larry.goldwasser@cushwake.com">larry.goldwasser@cushwake.com</a>		
4310 Transworld	Schiller Park	I	23,000	23,000	18'	Larry Goldwasser - Cushman & Wakefield (312) 470-2323	<a href="mailto:larry.goldwasser@cushwake.com">larry.goldwasser@cushwake.com</a>		
4205-4321 N. United Pkwy.	Schiller Park	I	5,000	5,000	16'	Larry Goldwasser - Cushman & Wakefield (312) 470-2323	<a href="mailto:larry.goldwasser@cushwake.com">larry.goldwasser@cushwake.com</a>		
10501 - 10505 Delta Pkwy.	Schiller Park	I	19,470	19,470	16'	Larry Goldwasser - Cushman & Wakefield (312) 470-2323	<a href="mailto:larry.goldwasser@cushwake.com">larry.goldwasser@cushwake.com</a>		
10508 N. United Pkwy.	Schiller Park	I	10,672	10,672	16'	Larry Goldwasser - Cushman & Wakefield (312) 470-2323	<a href="mailto:larry.goldwasser@cushwake.com">larry.goldwasser@cushwake.com</a>		
10509-10521 N. United Pkwy.	Schiller Park	I	32,000	12,000	16'	Larry Goldwasser - Cushman & Wakefield (312) 470-2323	<a href="mailto:larry.goldwasser@cushwake.com">larry.goldwasser@cushwake.com</a>		

State	Market	Address	City	Industrial/ Office/ Cold Storage	Availabilities (SF)		Clear Height	Listing Broker Contact	Broker Email
					Total	Minimum			
IL	Chicago	4250 - 4306 N. United Pkwy.	Schiller Park	I	108,040	27,010	21'	Larry Goldwasser - Cushman & Wakefield (312) 470-2323	<a href="mailto:larry.goldwasser@cushwake.com">larry.goldwasser@cushwake.com</a>
		16750 Vincennes Road	South Holland	I	202,902	106,961	22' - 24'	Walter Murphy - Lee & Associates of Illinois (773) 355-3017	<a href="mailto:wmurphy@lee-associates.com">wmurphy@lee-associates.com</a>
		1601 Atlantic Dr.	West Chicago	I	6,491	3,233	18'	Adam Johnson - NAI Hiffman (630) 317-0729	<a href="mailto:ajohnson@hiffman.com">ajohnson@hiffman.com</a>
		KTR - Crossroads DuPage (Land/BTS)	West Chicago	I	210,000	30,600	30'	Kirk Armour - CB Richard Ellis (847) 706 - 4030	<a href="mailto:kirk.armour@cbre.com">kirk.armour@cbre.com</a>
NJ	New Jersey	275 Omar Ave.	Avenel (12)	I	279,700	150,000	36'	Bill Waxman - CBRE (201) 712-5810	<a href="mailto:william.waxman@cbre.com">william.waxman@cbre.com</a>
		275 Omar Ave.	Avenel (12)	C	111,950	111,950	40'	Bill Waxman - CBRE (201) 712-5810	<a href="mailto:william.waxman@cbre.com">william.waxman@cbre.com</a>
		3025 Woodbridge Ave.	Edison	I	62,208	62,208	36'	Adam Citron - Jones Lang LaSalle (732) 590-4174	<a href="mailto:adam.citron@am.jll.com">adam.citron@am.jll.com</a>
		3001 Woodbridge Ave.	Edison	I	393,000	86,000	27'	Adam Citron - Jones Lang LaSalle (732) 590-4174	<a href="mailto:adam.citron@am.jll.com">adam.citron@am.jll.com</a>
		600 Meadowlands Pkwy.	Secaucus	I	9,600	2,400	24'	Brian Scheuer - Chaus Realty (201) 288-8818	<a href="mailto:bscheuerchaur@aol.com">bscheuerchaur@aol.com</a>
		600 Meadowlands Pkwy.	Secaucus	O	25,652	1,190	n/a	Brian Scheuer - Chaus Realty (201) 288-8818	<a href="mailto:bscheuerchaur@aol.com">bscheuerchaur@aol.com</a>
		iPort 12 - 8003 Industrial Ave.	Carteret	I	1,064,515	513,547	36'	Nate Demetsky - Jones Lang LaSalle (609) 672-3163	<a href="mailto:Nate.Demetsky@am.jll.com">Nate.Demetsky@am.jll.com</a>
NV	Las Vegas	3550 E. Post Rd.	Las Vegas	I/O	4,000	4,000	16'-30'	Spencer Pinter - Colliers (702) 836-3776	<a href="mailto:spinter@lvcolliers.com">spinter@lvcolliers.com</a>
		3585 E. Patrick Ln.	Las Vegas	I/O	17,800	4,385	16'-30'	Spencer Pinter - Colliers (702) 836-3776	<a href="mailto:spinter@lvcolliers.com">spinter@lvcolliers.com</a>
		3595 E. Patrick Ln.	Las Vegas	I/O	48,514	5,267	16'-30'	Spencer Pinter - Colliers (702) 836-3776	<a href="mailto:spinter@lvcolliers.com">spinter@lvcolliers.com</a>
		3755 E. Post Rd	Las Vegas	I/O	39,929	39,929	16'-30'	Spencer Pinter - Colliers (702) 836-3776	<a href="mailto:spinter@lvcolliers.com">spinter@lvcolliers.com</a>
		6275 S. Pearl St.	Las Vegas	I/O	27,362	11,000	16'-30'	Spencer Pinter - Colliers (702) 836-3776	<a href="mailto:spinter@lvcolliers.com">spinter@lvcolliers.com</a>
		6295 S. Pearl St.	Las Vegas	I/O	37,578	4,800	16'-30'	Spencer Pinter - Colliers (702) 836-3776	<a href="mailto:spinter@lvcolliers.com">spinter@lvcolliers.com</a>
		3655 E. Patrick Ln.	Las Vegas	I/O	11,703	5,104	16'-30'	Spencer Pinter - Colliers (702) 836-3776	<a href="mailto:spinter@lvcolliers.com">spinter@lvcolliers.com</a>
		6180 S. Pearl St.	Las Vegas	I/O	86,870	21,600	16'-30'	Spencer Pinter - Colliers (702) 836-3776	<a href="mailto:spinter@lvcolliers.com">spinter@lvcolliers.com</a>
		3650 E. Post Rd.	Las Vegas	I/O	11,661	11,661	16'-30'	Spencer Pinter - Colliers (702) 836-3776	<a href="mailto:spinter@lvcolliers.com">spinter@lvcolliers.com</a>
		6155 S. Sandhill Rd.	Las Vegas	I/O	20,728	6,050	16'-30'	Spencer Pinter - Colliers (702) 836-3776	<a href="mailto:spinter@lvcolliers.com">spinter@lvcolliers.com</a>
		6275 S. Sandhill Rd.	Las Vegas	I/O	15,000	15,000	16'-30'	Spencer Pinter - Colliers (702) 836-3776	<a href="mailto:spinter@lvcolliers.com">spinter@lvcolliers.com</a>
		6255 S. Sandhill Rd.	Las Vegas	I/O	4,800	4,800	16'-30'	Spencer Pinter - Colliers (702) 836-3776	<a href="mailto:spinter@lvcolliers.com">spinter@lvcolliers.com</a>
		7370 Dean Martin Dr.	Las Vegas	I/O	21,629	21,629	20'-24'	Jeremy Green - CBRE (702) 369-4883	<a href="mailto:jeremy.green@cbre.com">jeremy.green@cbre.com</a>
7440 Dean Martin Dr.	Las Vegas	I/O	43,208	21,350	20'-24'	Jeremy Green - CBRE (702) 369-4883	<a href="mailto:jeremy.green@cbre.com">jeremy.green@cbre.com</a>		
6445 Montessori St.	Las Vegas	I/O	71,678	71,678	30'	Mike Hillis & Susan Borst - CW (702) 688-6915	<a href="mailto:sborst@comre.com">sborst@comre.com</a>		
NV	Reno	Eagle Valley Industrial Center (Land/BTS)	McCarran	I	566,875	275,000	32'-36'	Eric Bennett - CBRE (775) 823-6963	<a href="mailto:eric.bennett@cbre.com">eric.bennett@cbre.com</a>
OH	Columbus	5650 Greenpoint Dr. North	Groveport	I	75,000	75,000	32'	Michael Mullady - CBRE (614) 430-5030	<a href="mailto:michael.mullady@cbre.com">michael.mullady@cbre.com</a>
PA	Harrisburg	3700 Industrial Rd.	Harrisburg	I	209,110	209,110	30'	Joe McDermott - CBRE (610) 251-5107	<a href="mailto:joe.mcdermott@cbre.com">joe.mcdermott@cbre.com</a>
		3700 Industrial Rd.	Harrisburg	C	178,479	82,682	30'	Joe McDermott - CBRE (610) 251-5107	<a href="mailto:joe.mcdermott@cbre.com">joe.mcdermott@cbre.com</a>
		3700 Industrial Rd.	Harrisburg	Truck Maint.	15,100	15,100	20'	Joe McDermott - CBRE (610) 251-5107	<a href="mailto:joe.mcdermott@cbre.com">joe.mcdermott@cbre.com</a>
PA	Carlisle	950 Centerville Road	Newville	I	570,000	300,000	32'	Michael Hess - CBRE (717) 540-2705	<a href="mailto:michael.hess@cbre.com">michael.hess@cbre.com</a>
TN	Nashville	104 Challenger Rd.	Portland	I	300,000	60,000	30'	Steve Pron - KTR Capital Partners (484) 530-1851	<a href="mailto:spron@ktrcapital.com">spron@ktrcapital.com</a>
		1125 Vaughn Dr.	Portland	I	504,000	504,000	32'	John Ward - Cassidy Turley (615) 301-2834	<a href="mailto:john.ward@cassidyturley.com">john.ward@cassidyturley.com</a>
TX	Dallas	5401 N. Riverside Dr. (Sublet)	Ft. Worth	I	658,692	250,000	40'	Paul Whitman - JLL (214) 438-6280	<a href="mailto:paul.whitman@am.jll.com">paul.whitman@am.jll.com</a>
TX	Houston	14430-14440 JFK Blvd.	Houston	I/O	56,000	13,440	24'	Justin Robinson Stream Realty Partners (713) 300-0304	<a href="mailto:jrobinson@streamrealty.com">jrobinson@streamrealty.com</a>
WI	Wisconsin	11100 W. Silver Spring Rd.	Milwaukee	I	127,400	28,286	22' - 24'	Samuel Dickman Jr. - The Dickman Company (414) 271-6100	<a href="mailto:sam-jr@dickmanrealestate.com">sam-jr@dickmanrealestate.com</a>

State	Market	Address	City	Industrial/ Office/ Cold Storage	Availabilities (SF)		Clear Height	Listing Broker Contact	Broker Email
					Total	Minimum			
<b><u>KTR Asset Management Contacts</u></b>									
		<b>Steve Butte - Partner - National</b> sbutte@ktrcapital.com (484) 530-1843							
		<b>Steve Pron - Senior Vice President - Midwest, NV</b> spron@ktrcapital.com (484) 530-1851							
		<b>Brad Stitchberry - Vice President - Southeast FL</b> bstitchberry@ktrcapital.com (954) 354-0290							
		<b>John Clowney - Vice President - GA, TX</b> jclowney@ktrcapital.com (919) 900-8323							
		<b>Al Corr - Senior Vice President - PA, NJ, CFL</b> acorr@ktrcapital.com (484) 530-1821							
		<b>Bob Andrews - Senior Vice President - CA, AZ, WA</b> bandrews@ktrcapital.com (213) 784-3656							
		<b>Kevin Apel - Vice President - Southern CA, AZ, WA</b> kapel@ktrcapital.com (213) 784-4429							
		<b>Renee Carroll - Asset Manager - NV</b> rcarroll@ktrcapital.com (702) 605-6508							
		<b>Marty Edmondson - Vice President - IL, OH</b> medmondson@ktrcapital.com (847) 737-4841							
		<b>Rob Turcott - Vice President - IL, WI</b> rturcott@ktrcapital.com (847) 737-4843							
		<b>Cane Napolitano - Southeast FL</b> cnapolitano@ktrcapital.com (954) 354-0249							

For Lease

180,473 SF Industrial  
Distribution Facility



2601 S. MALT AVENUE, COMMERCE, CA 90040



Owned and managed by:

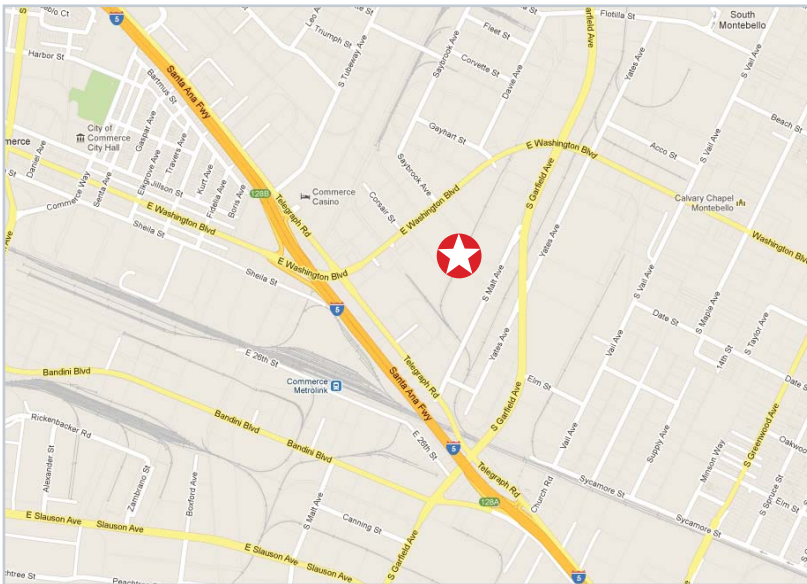

### PROPERTY SPECIFICATIONS

- Building Size: 180,473 sf
- Land Size: 387,248 sf
- Office Size: 9,837
- Loading: 34 DH / 3 GL
- Clear Height: 20' Minimum
- Power: 2,000 amps - 277/480 V, 3Ø
- Parking: 1.2:1 / 209 spaces
- Yard: Paved / Fenced
- Lease Rate: \$0.47 Net
- Cross Dock Loading
- Corporate Image Facility
- Covered Rail Dock
- T-5 Warehouse Lighting

Contact for more information:

**Dave Hess**  
Senior Director  
Direct: (213) 955-6412  
dave.hess@cushwake.com  
License No. 00866306

**Mike Foley**  
Senior Director  
Direct: (310) 525-1920  
mike.foley@cushwake.com  
License No. 00771079

FOR LEASE



180,473 SF Industrial  
Distribution Facility

2601 S. MALT AVENUE, COMMERCE, CA 90040

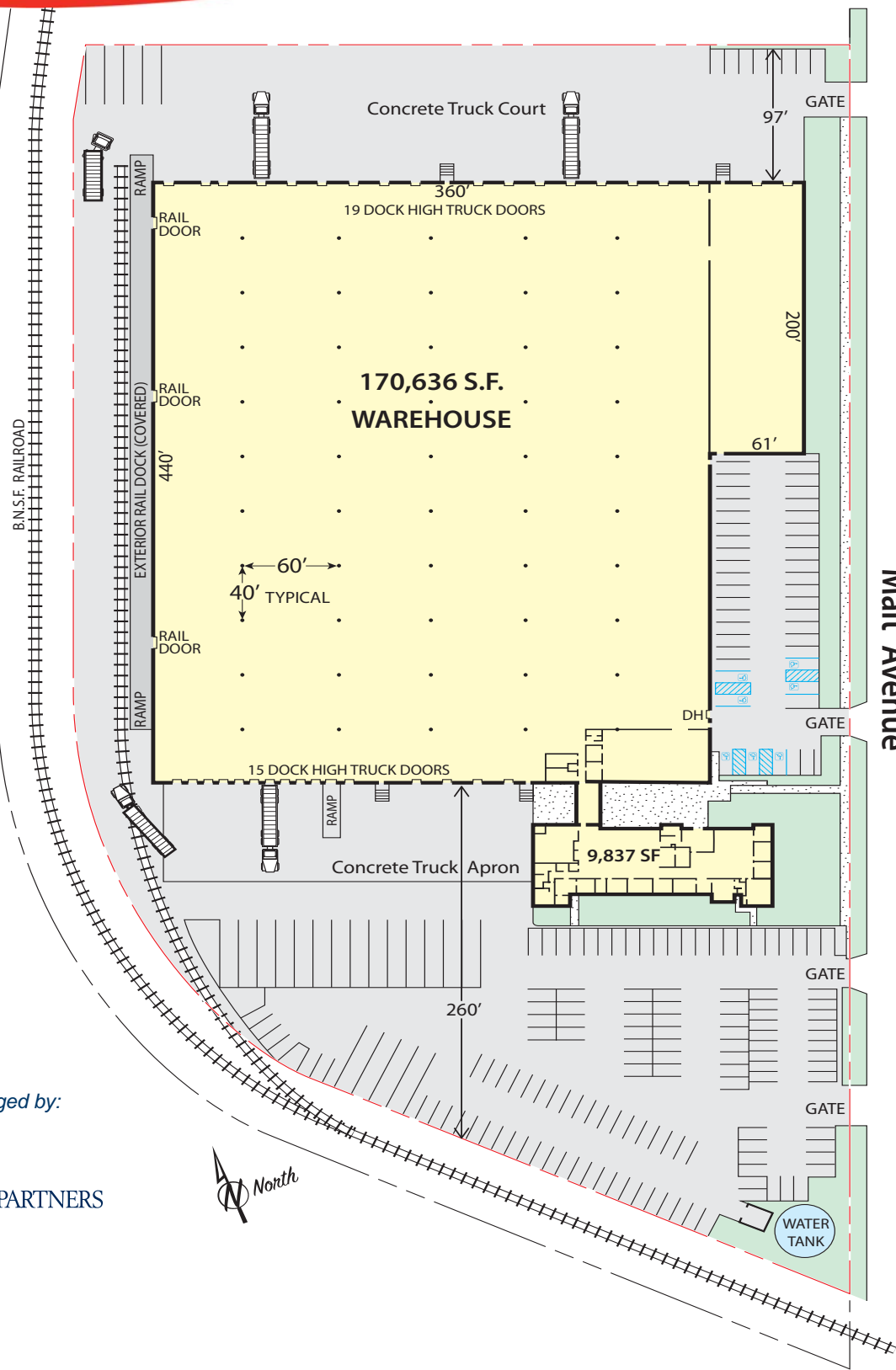

Owned and managed by:



Contact for more information:

**Dave Hess**  
Senior Director  
Direct: (213) 955-6412  
dave.hess@cushwake.com  
License No. 00866306

**Mike Foley**  
Senior Director  
Direct: (310) 525-1920  
mike.foley@cushwake.com  
License No. 00771079