

State	Market	Address	City	Industrial/ Office/ Cold Storage	Availabilities (SF)		Clear Height	Listing Broker Contact	Listing Broker Email
					Total	Minimum			
AZ	Southwest Phoenix	<a href="#">4901 W. Van Buren St.</a>	Phoenix	I	5,780	5,780	18'	Marc Hertzberg - Jones Lang LaSalle (602) 648-9219	<a href="mailto:marc.hertzberg@am.jll.com">marc.hertzberg@am.jll.com</a>
		<a href="#">4929 W. Van Buren St.</a>	Phoenix	I	74,642	37,321	24'	Marc Hertzberg - Jones Lang LaSalle (602) 648-9219	<a href="mailto:marc.hertzberg@am.jll.com">marc.hertzberg@am.jll.com</a>
		<a href="#">6111 W. Washington St. (Land/BTS)</a>	Phoenix	I	273,000	114,000	32'-36'	John Werstler - CBRE (602) 735-5504	<a href="mailto:john.werstler@cbre.com">john.werstler@cbre.com</a>
CA	Los Angeles	<a href="#">5560 E. 61st St.</a>	Commerce	I	41,056	41,056	30'	John McMillan - Cushman & Wakefield (310) 525-1905	<a href="mailto:john.mcmillan@cushwake.com">john.mcmillan@cushwake.com</a>
		<a href="#">6100 Garfield Ave. (Land/BTS)</a>	Commerce	I	620,000	152,000	36'	Zac Sakowski - JLL (424) 294-3429	<a href="mailto:zac.sakowski@am.jll.com">zac.sakowski@am.jll.com</a>
		<a href="#">350 W. Manville St.</a>	Compton	I	50,000	50,000	24'	Brad Levin - Daum Commercial (310) 538-6728	<a href="mailto:brad.levin@daumcommercial.com">brad.levin@daumcommercial.com</a>
		<a href="#">13169 Slover Ave.</a>	Fontana	I	184,755	69,720	32'	Chuck Belden - Cushman & Wakefield (909) 942-4640	<a href="mailto:chuck.belden@cushwake.com">chuck.belden@cushwake.com</a>
		<a href="#">13083 Slover Ave.</a>	Fontana	I	43,802	43,802	32'	Chuck Belden - Cushman & Wakefield (909) 942-4640	<a href="mailto:chuck.belden@cushwake.com">chuck.belden@cushwake.com</a>
		<a href="#">1990 S. Cucamonga Ave.</a>	Ontario	I	416,713	416,713	30'	Len Santoro - CBRE (909) 418-2158	<a href="mailto:len.santoro@cbre.com">len.santoro@cbre.com</a>
		<a href="#">9910 Nevada St. (Land/BTS)</a>	Redlands	I	425,940	425,940	32'	Jeff Smith - Lee & Associates (909) 373-2909	<a href="mailto:jsmith@lee-assoc.com">jsmith@lee-assoc.com</a>
CA	Bay Area	<a href="#">9425 Nevada St. (Land/BTS)</a>	Redlands	I	215,684	215,684	32'	Chuck Belden - Cushman & Wakefield (909) 942-4640	<a href="mailto:chuck.belden@cushwake.com">chuck.belden@cushwake.com</a>
		<a href="#">8024-8058 Central Ave.</a>	Newark	I/O	22,963	7,801	20'	Joe Kelly - CBRE (408) 453-7474	<a href="mailto:joe.kelly@cbre.com">joe.kelly@cbre.com</a>
FL	Southeast Florida	<a href="#">1001 Broken Sound Pkwy.</a>	Boca Raton	I/O	10,250	10,250	16'	Jeff Kelly - CBRE (561) 393-1621	<a href="mailto:jeffrey.kelly@cbre.com">jeffrey.kelly@cbre.com</a>
		<a href="#">1225 Broken Sound Pkwy.</a>	Boca Raton	I/O	16,281	5,720	16'	Jeff Kelly - CBRE (561) 393-1621	<a href="mailto:jeffrey.kelly@cbre.com">jeffrey.kelly@cbre.com</a>
		<a href="#">4801 Johnson Rd.</a>	Coconut Creek	I/O	6,967	3,060	24'	Christopher Thomson - Cushman & Wakefield (561) 227-2020	<a href="mailto:christopher.thomson@cushwake.com">christopher.thomson@cushwake.com</a>
		<a href="#">5251-5255 NW 33rd Ave. Bldg. 1</a>	Cypress Creek	O	5,289	731	9'	Peter Sheridan - JLL (954) 653-3230	<a href="mailto:Peter.Sheridan@am.jll.com">Peter.Sheridan@am.jll.com</a>
		<a href="#">5231-5237 NW 33rd Ave. Bldg. 2</a>	Cypress Creek	O	6,135	2,600	9'	Peter Sheridan - JLL (954) 653-3230	<a href="mailto:Peter.Sheridan@am.jll.com">Peter.Sheridan@am.jll.com</a>
		<a href="#">5201-5209 NW 33rd Ave. Bldg. 3</a>	Cypress Creek	O	6,761	2,099	9'	Peter Sheridan - JLL (954) 653-3230	<a href="mailto:Peter.Sheridan@am.jll.com">Peter.Sheridan@am.jll.com</a>
		<a href="#">5211-5219 NW 33rd Ave. Bldg. 4</a>	Cypress Creek	O	4,349	1,988	9'	Peter Sheridan - JLL (954) 653-3230	<a href="mailto:Peter.Sheridan@am.jll.com">Peter.Sheridan@am.jll.com</a>
		<a href="#">5221-5229 NW 33rd Ave. Bldg. 5</a>	Cypress Creek	O	11,332	2,171	9'	Peter Sheridan - JLL (954) 653-3230	<a href="mailto:Peter.Sheridan@am.jll.com">Peter.Sheridan@am.jll.com</a>
		<a href="#">5241-5249 NW 33rd Ave. Bldg. 6</a>	Cypress Creek	O	8,264	1,463	9'	Peter Sheridan - JLL (954) 653-3230	<a href="mailto:Peter.Sheridan@am.jll.com">Peter.Sheridan@am.jll.com</a>
		<a href="#">3437-3453 NW 55th St. Bldg.1</a>	Cypress Creek	I/O	8,864	1,611	14'	Peter Sheridan - JLL (954) 653-3230	<a href="mailto:Peter.Sheridan@am.jll.com">Peter.Sheridan@am.jll.com</a>
		<a href="#">3467-3475 NW 55th St. Bldg. 2</a>	Cypress Creek	I/O	3,638	610	14'	Peter Sheridan - JLL (954) 653-3230	<a href="mailto:Peter.Sheridan@am.jll.com">Peter.Sheridan@am.jll.com</a>
		<a href="#">3421-3435 NW 55th St. Bldg. 3</a>	Cypress Creek	I/O	3,499	902	14'	Peter Sheridan - JLL (954) 653-3230	<a href="mailto:Peter.Sheridan@am.jll.com">Peter.Sheridan@am.jll.com</a>
		<a href="#">3403-3411 NW 55th St. Bldg. 4</a>	Cypress Creek	I/O	5,289	859	14'	Peter Sheridan - JLL (954) 653-3230	<a href="mailto:Peter.Sheridan@am.jll.com">Peter.Sheridan@am.jll.com</a>
		<a href="#">3347-3355 NW 55th St. Bldg. 5</a>	Cypress Creek	I/O	5,783	2,597	14'	Peter Sheridan - JLL (954) 653-3230	<a href="mailto:Peter.Sheridan@am.jll.com">Peter.Sheridan@am.jll.com</a>
		<a href="#">3361-3375 NW 55th St. Bldg. 6</a>	Cypress Creek	I/O	10,173	1,825	14'	Peter Sheridan - JLL (954) 653-3230	<a href="mailto:Peter.Sheridan@am.jll.com">Peter.Sheridan@am.jll.com</a>
		<a href="#">3323-3337 NW 55th St. Bldg. 7</a>	Cypress Creek	I/O	8,186	1,056	14'	Peter Sheridan - JLL (954) 653-3230	<a href="mailto:Peter.Sheridan@am.jll.com">Peter.Sheridan@am.jll.com</a>
		<a href="#">3301-3309 NW 55th St. Bldg. 8</a>	Cypress Creek	I/O	8,309	577	14'	Peter Sheridan - JLL (954) 653-3230	<a href="mailto:Peter.Sheridan@am.jll.com">Peter.Sheridan@am.jll.com</a>
		<a href="#">5400 NW 35th Ave.</a>	Cypress Creek	I	66,075	66,075	25'	Tom O'Loughlin - CBRE (954) 356-0468	<a href="mailto:tom.oloughlin@cbre.com">tom.oloughlin@cbre.com</a>
		<a href="#">602 - 668 S. Military Trl.</a>	Deerfield Beach	I/O	19,617	1,843	16'	Owen Sagar - CBRE (561) 393-1634	<a href="mailto:owen.sagar@cbre.com">owen.sagar@cbre.com</a>
		<a href="#">674 - 692 S. Military Trl.</a>	Deerfield Beach	I	24,613	7,200	18'	Tom O'Loughlin - CBRE (954) 356-0468	<a href="mailto:tom.oloughlin@cbre.com">tom.oloughlin@cbre.com</a>
<a href="#">700 - 710 S. Military Trl.</a>	Deerfield Beach	I	27,996	9,885	18'	Tom O'Loughlin - CBRE (954) 356-0468	<a href="mailto:tom.oloughlin@cbre.com">tom.oloughlin@cbre.com</a>		
<a href="#">712 - 734 S. Military Trl.</a>	Deerfield Beach	I	16,008	16,008	24'	Tom O'Loughlin - CBRE (954) 356-0468	<a href="mailto:tom.oloughlin@cbre.com">tom.oloughlin@cbre.com</a>		
<a href="#">736 - 774 S. Military Trl.</a>	Deerfield Beach	I	15,325	15,325	24'	Tom O'Loughlin - CBRE (954) 356-0468	<a href="mailto:tom.oloughlin@cbre.com">tom.oloughlin@cbre.com</a>		
<a href="#">776 - 858 S. Military Trl.</a>	Deerfield Beach	I/O	21,721	1,843	16'	Owen Sagar - CBRE (561) 393-1634	<a href="mailto:owen.sagar@cbre.com">owen.sagar@cbre.com</a>		
<a href="#">1395 NW 17th Ave.</a>	Delray Beach	I/O	2,930	1,000	20'	Christopher Thomson - Cushman & Wakefield (561) 227-2020	<a href="mailto:christopher.thomson@cushwake.com">christopher.thomson@cushwake.com</a>		
<a href="#">430 S. Congress Ave.</a>	Delray Beach	I	41,334	9,013	24'	Jeff Kelly - CBRE (561) 393-1621	<a href="mailto:jeffrey.kelly@cbre.com">jeffrey.kelly@cbre.com</a>		
<a href="#">Miami Int'l Distribution Center</a>	Doral	I	335,841	100,752	36'	Jose Juncadella - Fairchild Partners (305) 668-0620	<a href="mailto:jjuncadella@fairchildpartners.com">jjuncadella@fairchildpartners.com</a>		
<a href="#">Miami Int'l Distribution Center (Land/BTS)</a>	Doral	I	94,000	94,000	36'	Jose Juncadella - Fairchild Partners (305) 668-0620	<a href="mailto:jjuncadella@fairchildpartners.com">jjuncadella@fairchildpartners.com</a>		
<a href="#">1901-1949 Tigertail Blvd.</a>	Hollywood	I	14,000	7,000	22'	David Wigoda - Jones Lang Lasalle (954) 829-3737	<a href="mailto:david.wigoda@am.jll.com">david.wigoda@am.jll.com</a>		

State	Market	Address	City	Industrial/ Office/ Cold Storage	Availabilities (SF)		Clear Height	Listing Broker Contact	Listing Broker Email
					Total	Minimum			
FL	Southeast Florida	<a href="#">3601-3613 N. 29th Ave.</a>	Hollywood	I	9,150	9,150	24'	David Wigoda - Jones Lang Lasalle (954) 829-3737	<a href="mailto:david.wigoda@am.jll.com">david.wigoda@am.jll.com</a>
		<a href="#">5553 Anglers Ave. (Bldg 4)</a>	Hollywood	I	10,692	10,692	21'	David Wigoda - Jones Lang Lasalle (954) 829-3737	<a href="mailto:david.wigoda@am.jll.com">david.wigoda@am.jll.com</a>
		<a href="#">5555 Anglers Ave.</a>	Hollywood	O	9,277	1,000	16'	David Wigoda - Jones Lang Lasalle (954) 829-3737	<a href="mailto:david.wigoda@am.jll.com">david.wigoda@am.jll.com</a>
		<a href="#">3201 SW 22nd St.</a>	Pembroke Pines	I	66,095	66,095	30'	Rick Etner - Cushman & Wakefield (954) 771-0800	<a href="mailto:rick.etner@cushwake.com">rick.etner@cushwake.com</a>
		<a href="#">Seneca North Industrial Park (Land/BTS)</a>	Pembroke Pines	I	36,300	36,300	30'	Rick Etner - Cushman & Wakefield (954) 771-0800	<a href="mailto:rick.etner@cushwake.com">rick.etner@cushwake.com</a>
		<a href="#">645 NW Enterprise Dr.</a>	Port St. Lucie	I	16,800	2,400	18'	Derrick Christenson - Christenson Commercial RE (772) 419-5076	<a href="mailto:derricksoldit@aol.com">derricksoldit@aol.com</a>
		<a href="#">651 NW Enterprise Dr.</a>	Port St. Lucie	I	13,824	1,536	18'	Derrick Christenson - Christenson Commercial RE (772) 419-5076	<a href="mailto:derricksoldit@aol.com">derricksoldit@aol.com</a>
		<a href="#">7540 Byron Dr.</a>	Riviera Beach	I	104,640	104,640	32'	Christopher Thomson - Cushman & Wakefield (561) 227-2020	<a href="mailto:christopher.thomson@cushwake.com">christopher.thomson@cushwake.com</a>
		<a href="#">7655 Enterprise Dr.</a>	Riviera Beach	I	7,650	1,600	18'	Christopher Thomson - Cushman & Wakefield (561) 227-2020	<a href="mailto:christopher.thomson@cushwake.com">christopher.thomson@cushwake.com</a>
		<a href="#">7656 Byron Dr.</a>	Riviera Beach	I	20,123	1,592	18'	Christopher Thomson - Cushman & Wakefield (561) 227-2020	<a href="mailto:christopher.thomson@cushwake.com">christopher.thomson@cushwake.com</a>
		<a href="#">9439 W. Commercial Blvd.</a>	Tamarac	I	84,100	84,100	35'	Tom O'Loughlin - CBRE (954) 356-0468	<a href="mailto:tom.oloughlin@cbre.com">tom.oloughlin@cbre.com</a>
FL	Tampa	<a href="#">4023 Tampa Rd.</a>	Oldsmar	I/O	30,564	9,564	20'	Alan Feldshue - Colliers Arnold (727) 442-7296	<a href="mailto:alan.feldshue@colliers.com">alan.feldshue@colliers.com</a>
		<a href="#">4025 Tampa Rd.</a>	Oldsmar	I/O	19,638	750	20'	Alan Feldshue - Colliers Arnold (727) 442-7296	<a href="mailto:alan.feldshue@colliers.com">alan.feldshue@colliers.com</a>
		<a href="#">4027 Tampa Rd.</a>	Oldsmar	I	46,000	16,000	22'	John Dunphy - Jones Lang LaSalle (813) 387-1312	<a href="mailto:JohnC.Dunphy@am.jll.com">JohnC.Dunphy@am.jll.com</a>
		<a href="#">4029 Tampa Rd. (Sublet)</a>	Oldsmar	I	94,000	18,000	22'	John Dunphy - Jones Lang LaSalle (813) 387-1312	<a href="mailto:JohnC.Dunphy@am.jll.com">JohnC.Dunphy@am.jll.com</a>
FL	Orlando	<a href="#">38 Skyline Dr.</a>	Lake Mary	I	60,500	25,000	32'	Bo Bradford - Lee & Associates (321) 281-8502	<a href="mailto:bbradford@lee-associates.com">bbradford@lee-associates.com</a>
		<a href="#">7000 Kingspointe Parkway</a>	Orlando	I	42,354	42,354	30'	Bo Bradford - Lee & Associates (321) 281-8502	<a href="mailto:bbradford@lee-associates.com">bbradford@lee-associates.com</a>
GA	Atlanta	<a href="#">1650 Horizon Pky</a>	Buford	I	106,440	20,480	28'	Mark Hawks - CBRE (404) 504-5978	<a href="mailto:mark.hawks@cbre.com">mark.hawks@cbre.com</a>
		<a href="#">1500 Distribution Ct.</a>	Lithia Springs	I	35,533	35,533	24'	Chris Miller - NAI Brannen Goddard (404) 812-4084	<a href="mailto:cmiller@naibg.com">cmiller@naibg.com</a>
		<a href="#">1575 Distribution Ct.</a>	Lithia Springs	I	85,000	85,000	26'	Chris Miller - NAI Brannen Goddard (404) 812-4084	<a href="mailto:cmiller@naibg.com">cmiller@naibg.com</a>
		<a href="#">220 Greenwood Ct.</a>	McDonough	I	504,000	240,000	30'	Chris Copenhaver - Cushman & Wakefield	<a href="mailto:chris.copenhaver@cushwake.com">chris.copenhaver@cushwake.com</a>
IL	Chicago	<a href="#">200 S Mitchell Ct.</a>	Addison	I	85,385	85,385	22'	Jeff Fischer - NAI Hiffman (630) 317 - 0726	<a href="mailto:jfischer@hiffman.com">jfischer@hiffman.com</a>
		<a href="#">5619 W. 115th St.</a>	Alsip	I	170,563	170,563	28'	Larry Johnson - CB Richard Ellis (630) 573 - 7099	<a href="mailto:larry.johnson@cbre.com">larry.johnson@cbre.com</a>
		<a href="#">3557 Butterfield Rd.</a>	Aurora	I	88,114	30,000	30'	Brian Kling - Colliers International (847) 698 - 8223	<a href="mailto:brian.kling@colliers.com">brian.kling@colliers.com</a>
		<a href="#">7447 Central Ave.</a>	Bedford Park	I	62,500	62,500	21'	Steve Connolly - NAI Hiffman (630) 639-0642	<a href="mailto:sconnolly@hiffman.com">sconnolly@hiffman.com</a>
		<a href="#">595 Territorial Dr.</a>	Bolingbrook	I	67,904	33,745	28'	Terry Grapenthin - Cawley Chicago (630) 810-1160	<a href="mailto:tgrape@cawleychicago.com">tgrape@cawleychicago.com</a>
		<a href="#">513 Express Center Dr.</a>	Chicago	I	138,000	69,000	24'	Matt Mulvihill - CBRE (847) 706-4964	<a href="mailto:matt.mulvihill@cbre.com">matt.mulvihill@cbre.com</a>
		<a href="#">3100-3250 S. Central Ave.</a>	Cicero	I	220,685	10,134	14'-22'	Tom Condon - Colliers International (847) 698-8212	<a href="mailto:tcondon@colliers.com">tcondon@colliers.com</a>
		<a href="#">105 E. Oakton St.</a>	Des Plaines	I	100,227	100,227	23'	Matthew Stauber - Colliers International (847) 698-8236	<a href="mailto:matthew.stauber@colliers.com">matthew.stauber@colliers.com</a>
		<a href="#">801 Chase Ave.</a>	Elk Grove Village	I	10,473	4,090	18'	Rick Daly - Darwin Realty (630) 782-9520	<a href="mailto:rdaly@darwinrealty.com">rdaly@darwinrealty.com</a>
		<a href="#">1250 Arthur Ave.</a>	Elk Grove Village	I	96,382	41,491	20'	Chris Nelson - Lee & Associates of Illinois (773) 355-3011	<a href="mailto:cnelson@lee-associates.com">cnelson@lee-associates.com</a>
		<a href="#">3710 N. River Rd.</a>	Franklin Park	I	79,961	20,000	30'	Matt Mulvihill - CBRE (847) 706-4964	<a href="mailto:matt.mulvihill@cbre.com">matt.mulvihill@cbre.com</a>
		<a href="#">10800-10900 W. Belmont Ave.</a>	Franklin Park	I	66,417	66,417	16'-24'	Larry Goldwasser - Cushman & Wakefield (312) 470-2323	<a href="mailto:larry.goldwasser@cushwake.com">larry.goldwasser@cushwake.com</a>
		<a href="#">1100 Lakeside Dr.</a>	Gurnee	I	39,364	39,364	18'	Keith Puritz - CBRE (847) 572-1410	<a href="mailto:keith.puritz@cbre.com">keith.puritz@cbre.com</a>
		<a href="#">1820 Northwestern Ave.</a>	Gurnee	I	24,000	24,000	22'	Robin Stolberg Jones Lang LaSalle (312) 228-3218	<a href="mailto:robin.stolberg@am.jll.com">robin.stolberg@am.jll.com</a>
		<a href="#">1400-1456 Norwood Dr.</a>	Itasca	I	33,632	14,154	16'	Jeff Janda - Lee & Associates of Illinois (773) 355-3015	<a href="mailto:jjanda@lee-associates.com">jjanda@lee-associates.com</a>
<a href="#">2407 - 2457 W. North Ave.</a>	Melrose Park	I	205,998	49,763	30'	John Suerth - CBRE (847) 706-4929	<a href="mailto:john.suerth@cbre.com">john.suerth@cbre.com</a>		
<a href="#">1660 Wall St.</a>	Mt. Prospect	I	108,732	30,000	30'	Jason West - Cushman & Wakefield (847) 518-3210	<a href="mailto:jason.west@cushwake.com">jason.west@cushwake.com</a>		
<a href="#">3701-3749 N. 25th Ave.</a>	Schiller Park	I	9,257	9,257	16' & 18'	Tom Rodeno - Colliers International (847) 698-8231	<a href="mailto:tom.rodeno@colliers.com">tom.rodeno@colliers.com</a>		

State	Market	Address	City	Industrial/ Office/ Cold Storage	Availabilities (SF)		Clear Height	Listing Broker Contact	Listing Broker Email
					Total	Minimum			
IL	Chicago	<a href="#">10524 N. United Pkwy.</a>	Schiller Park	I	19,500	19,500	16'	Larry Goldwasser - Cushman & Wakefield (312) 470-2323	<a href="mailto:larry.goldwasser@cushwake.com">larry.goldwasser@cushwake.com</a>
		<a href="#">4136 N. United Pkwy.</a>	Schiller Park	I	107,040	107,040	22'	Larry Goldwasser - Cushman & Wakefield (312) 470-2323	<a href="mailto:larry.goldwasser@cushwake.com">larry.goldwasser@cushwake.com</a>
		<a href="#">4210 Transworld</a>	Schiller Park	I	16,200	16,200	16'	Larry Goldwasser - Cushman & Wakefield (312) 470-2323	<a href="mailto:larry.goldwasser@cushwake.com">larry.goldwasser@cushwake.com</a>
		<a href="#">4310 Transworld</a>	Schiller Park	I	23,000	23,000	18'	Larry Goldwasser - Cushman & Wakefield (312) 470-2323	<a href="mailto:larry.goldwasser@cushwake.com">larry.goldwasser@cushwake.com</a>
		<a href="#">4205-4321 N. United Pkwy.</a>	Schiller Park	I	5,000	5,000	16'	Larry Goldwasser - Cushman & Wakefield (312) 470-2323	<a href="mailto:larry.goldwasser@cushwake.com">larry.goldwasser@cushwake.com</a>
		<a href="#">10501 - 10505 Delta Pkwy.</a>	Schiller Park	I	19,470	19,470	16'	Larry Goldwasser - Cushman & Wakefield (312) 470-2323	<a href="mailto:larry.goldwasser@cushwake.com">larry.goldwasser@cushwake.com</a>
		<a href="#">10508 N. United Pkwy.</a>	Schiller Park	I	10,672	10,672	16'	Larry Goldwasser - Cushman & Wakefield (312) 470-2323	<a href="mailto:larry.goldwasser@cushwake.com">larry.goldwasser@cushwake.com</a>
		<a href="#">10509-10521 N. United Pkwy.</a>	Schiller Park	I	20,000	8,000	16'	Larry Goldwasser - Cushman & Wakefield (312) 470-2323	<a href="mailto:larry.goldwasser@cushwake.com">larry.goldwasser@cushwake.com</a>
		<a href="#">10525 Delta Parkway</a>	Schiller Park	I	29,500	29,500	18'	Larry Goldwasser - Cushman & Wakefield (312) 470-2323	<a href="mailto:larry.goldwasser@cushwake.com">larry.goldwasser@cushwake.com</a>
		<a href="#">4250 - 4306 N. United Pkwy.</a>	Schiller Park	I	108,040	27,010	21'	Larry Goldwasser - Cushman & Wakefield (312) 470-2323	<a href="mailto:larry.goldwasser@cushwake.com">larry.goldwasser@cushwake.com</a>
		<a href="#">1601 Atlantic Dr.</a>	West Chicago	I	3,258	3,258	18'	Adam Johnson - NAI Hiffman (630) 317-0729	<a href="mailto:ajohnson@hiffman.com">ajohnson@hiffman.com</a>
		<a href="#">KTR - Crossroads DuPage (Land/BTS)</a>	West Chicago	I	210,000	30,600	30'	Kirk Armour - CB Richard Ellis (847) 706 - 4030	<a href="mailto:kirk.armour@cbre.com">kirk.armour@cbre.com</a>
		NJ	New Jersey	<a href="#">275 Omar Ave.</a>	Avenel (12)	I	279,700	150,000	36'
<a href="#">275 Omar Ave.</a>	Avenel (12)			C	111,950	111,950	40'	Bill Waxman - CBRE (201) 712-5810	<a href="mailto:william.waxman@cbre.com">william.waxman@cbre.com</a>
<a href="#">iPort 12 - 8003 Industrial Ave.</a>	Carteret			I	1,064,515	250,000	36'	Nate Demetsky - Jones Lang LaSalle (609) 672-3163	<a href="mailto:Nate.Demetsky@am.jll.com">Nate.Demetsky@am.jll.com</a>
<a href="#">3001 Woodbridge Ave.</a>	Edison			I	393,000	86,000	27'	Adam Citron - Jones Lang LaSalle (732) 590-4174	<a href="mailto:adam.citron@am.jll.com">adam.citron@am.jll.com</a>
<a href="#">600 Meadowlands Pkwy.</a>	Secaucus			I	9,600	2,400	24'	Brian Scheuer - Chaus Realty (201) 288-8818	<a href="mailto:bscheuerchausr@aol.com">bscheuerchausr@aol.com</a>
<a href="#">600 Meadowlands Pkwy.</a>	Secaucus			O	25,652	2,254	n/a	Brian Scheuer - Chaus Realty (201) 288-8818	<a href="mailto:bscheuerchausr@aol.com">bscheuerchausr@aol.com</a>
<a href="#">Interstate Blvd. (Land/BTS)</a>	South Brunswick			I	594,000	200,000	36'	Jason Goldman - Cushman & Wakefield (732) 452-6170	<a href="mailto:Jason.goldman@cushwake.com">Jason.goldman@cushwake.com</a>
<a href="#">100 Hollister Rd.</a>	Teterboro			O	6,301	6,301	n/a	Scott Perkins - NAI Hanson (201) 478-7388	<a href="mailto:sp Perkins@naihanson.com">sp Perkins@naihanson.com</a>
NV	Las Vegas	<a href="#">1385 Pama Ln.</a>	Las Vegas	I	78,829	16,338	24' - 28'	Susan Borst - Commerce/Cushman & Wakefield (702) 688-6915	<a href="mailto:borst@comre.com">borst@comre.com</a>
		<a href="#">3550 E. Post Rd.</a>	Las Vegas	I/O	4,000	4,000	16'-22'	Spencer Pinter - Colliers (702) 836-3776	<a href="mailto:spinter@lvcolliers.com">spinter@lvcolliers.com</a>
		<a href="#">3585 E. Patrick Ln.</a>	Las Vegas	I/O	17,800	4,385	20'-22'	Spencer Pinter - Colliers (702) 836-3776	<a href="mailto:spinter@lvcolliers.com">spinter@lvcolliers.com</a>
		<a href="#">3595 E. Patrick Ln.</a>	Las Vegas	I/O	31,296	5,267	20'-22'	Spencer Pinter - Colliers (702) 836-3776	<a href="mailto:spinter@lvcolliers.com">spinter@lvcolliers.com</a>
		<a href="#">6295 S. Pearl St.</a>	Las Vegas	I/O	37,578	4,800	24' - 28'	Spencer Pinter - Colliers (702) 836-3776	<a href="mailto:spinter@lvcolliers.com">spinter@lvcolliers.com</a>
		<a href="#">3655 E. Patrick Ln.</a>	Las Vegas	I/O	11,703	5,104	20' - 22'	Spencer Pinter - Colliers (702) 836-3776	<a href="mailto:spinter@lvcolliers.com">spinter@lvcolliers.com</a>
		<a href="#">6180 S. Pearl St.</a>	Las Vegas	I/O	21,600	21,600	30'	Spencer Pinter - Colliers (702) 836-3776	<a href="mailto:spinter@lvcolliers.com">spinter@lvcolliers.com</a>
		<a href="#">6275 S. Pearl St.</a>	Las Vegas	I/O	27,362	11,000	24'	Spencer Pinter - Colliers (702) 836-3776	<a href="mailto:spinter@lvcolliers.com">spinter@lvcolliers.com</a>
		<a href="#">3650 E. Post Rd.</a>	Las Vegas	I/O	11,661	11,661	28'	Spencer Pinter - Colliers (702) 836-3776	<a href="mailto:spinter@lvcolliers.com">spinter@lvcolliers.com</a>
		<a href="#">6155 S. Sandhill Rd.</a>	Las Vegas	I/O	20,728	6,050	24'	Spencer Pinter - Colliers (702) 836-3776	<a href="mailto:spinter@lvcolliers.com">spinter@lvcolliers.com</a>
		<a href="#">6255 S. Sandhill Rd.</a>	Las Vegas	I/O	4,800	4,800	20'	Spencer Pinter - Colliers (702) 836-3776	<a href="mailto:spinter@lvcolliers.com">spinter@lvcolliers.com</a>
NV	Reno	<a href="#">Eagle Valley Industrial Center (Land/BTS)</a>	McCarran	I	566,875	275,000	32'-36'	Eric Bennett - CBRE (775) 823-6963	<a href="mailto:eric.bennett@cbre.com">eric.bennett@cbre.com</a>
OH	Columbus	<a href="#">5650 Greenpoint Dr. North</a>	Groveport	I	75,000	75,000	32'	Michael Mullady - CBRE (614) 430-5030	<a href="mailto:michael.mullady@cbre.com">michael.mullady@cbre.com</a>
PA	Harrisburg	<a href="#">3700 Industrial Rd.</a>	Harrisburg	I	195,422	195,422	30'	Michael Zerbe - Colliers (610) 684-1853	<a href="mailto:michael.zerbe@colliers.com">michael.zerbe@colliers.com</a>
		<a href="#">3700 Industrial Rd.</a>	Harrisburg	O	16,646	16,646	n/a	Chris Cummings - Colliers (404) 877-9255	<a href="mailto:chris.cummings@colliers.com">chris.cummings@colliers.com</a>
		<a href="#">3700 Industrial Rd.</a>	Harrisburg	C	190,580	91,417	30'-34'	Michael Zerbe - Colliers (610) 684-1853	<a href="mailto:michael.zerbe@colliers.com">michael.zerbe@colliers.com</a>
PA	Carlisle	<a href="#">950 Centerville Rd.</a>	Newville	I	570,000	300,000	32'	Michael Hess - CBRE (717) 540-2705	<a href="mailto:michael.hess@cbre.com">michael.hess@cbre.com</a>
TN	Nashville	<a href="#">104 Challenger Rd.</a>	Portland	I	300,000	60,000	30'	John Ward - Cassidy Turley (615) 301-2834	<a href="mailto:john.ward@cassidyrturley.com">john.ward@cassidyrturley.com</a>
		<a href="#">1125 Vaughn Dr.</a>	Portland	I	504,000	504,000	32'	John Ward - Cassidy Turley (615) 301-2834	<a href="mailto:john.ward@cassidyrturley.com">john.ward@cassidyrturley.com</a>
TX	Houston	<a href="#">14430-14440 JFK Blvd.</a>	Houston	I/O	56,000	13,440	24'	Justin Robinson Stream Realty Partners (713) 300-0304	<a href="mailto:jrobinson@streamrealty.com">jrobinson@streamrealty.com</a>

State	Market	Address	City	Industrial/ Office/ Cold Storage	Availabilities (SF)		Clear Height	Listing Broker Contact	Listing Broker Email
					Total	Minimum			
WA	Seattle	<a href="#">20024 87th Avenue South</a>	Kent	I	144,000	144,000	24'	Matt Wood - Kidder Mathews (206) 248-7292	<a href="mailto:mwood@kiddermathews.com">mwood@kiddermathews.com</a>
		<a href="#">19802 87th Avenue South</a>	Kent	I	91,200	43,200	24'	Matt Wood - Kidder Mathews (206) 248-7292	<a href="mailto:mwood@kiddermathews.com">mwood@kiddermathews.com</a>
		<a href="#">8609-8633 S 208th St.</a>	Kent	I	84,638	14,400	22'	Matt Wood - Kidder Mathews (206) 248-7292	<a href="mailto:mwood@kiddermathews.com">mwood@kiddermathews.com</a>
		<a href="#">20201 87th Avenue South</a>	Kent	I	57,600	57,600	30'	Matt Wood - Kidder Mathews (206) 248-7292	<a href="mailto:mwood@kiddermathews.com">mwood@kiddermathews.com</a>
		<a href="#">20411 87th Avenue South</a>	Kent	I	43,200	43,200	30'	Matt Wood - Kidder Mathews (206) 248-7292	<a href="mailto:mwood@kiddermathews.com">mwood@kiddermathews.com</a>
		<a href="#">20413 87th Avenue South</a>	Kent	I	28,800	28,800	30'	Matt Wood - Kidder Mathews (206) 248-7292	<a href="mailto:mwood@kiddermathews.com">mwood@kiddermathews.com</a>
		<a href="#">8661 S 208th St.</a>	Kent	I	39,067	39,067	16'	Matt Wood - Kidder Mathews (206) 248-7292	<a href="mailto:mwood@kiddermathews.com">mwood@kiddermathews.com</a>
		<a href="#">20848 84th Avenue South</a>	Kent	I	36,233	36,233	24'	Matt Wood - Kidder Mathews (206) 248-7292	<a href="mailto:mwood@kiddermathews.com">mwood@kiddermathews.com</a>
		<a href="#">20413 89th Avenue South</a>	Kent	I	32,400	32,400	30'	Matt Wood - Kidder Mathews (206) 248-7292	<a href="mailto:mwood@kiddermathews.com">mwood@kiddermathews.com</a>
		<a href="#">8435 South 208th St.</a>	Kent	I	26,864	26,864	22'	Matt Wood - Kidder Mathews (206) 248-7292	<a href="mailto:mwood@kiddermathews.com">mwood@kiddermathews.com</a>
		<a href="#">19815 85th Avenue South</a>	Kent	I	24,750	24,750	24'	Matt Wood - Kidder Mathews (206) 248-7292	<a href="mailto:mwood@kiddermathews.com">mwood@kiddermathews.com</a>
		<a href="#">19821 87th Avenue South</a>	Kent	I	18,000	18,000	24'	Matt Wood - Kidder Mathews (206) 248-7292	<a href="mailto:mwood@kiddermathews.com">mwood@kiddermathews.com</a>
		<a href="#">21040 84th Avenue South</a>	Kent	Retail	3,280	3,280	N/A	Matt Wood - Kidder Mathews (206) 248-7292	<a href="mailto:mwood@kiddermathews.com">mwood@kiddermathews.com</a>
WI	Milwaukee	<a href="#">11100 W. Silver Spring Rd.</a>	Milwaukee	I	127,400	28,286	22' - 24'	Samuel Dickman Jr. - The Dickman Company (414) 271-6100	<a href="mailto:sam-jr@dickmanrealestate.com">sam-jr@dickmanrealestate.com</a>

**KTR Asset Management Contacts**

**Steve Butte - Partner - National**

sbutte@ktrcapital.com (484) 530-1843

**Britt Sanders - Business Development - National**

bsanders@ktrcapital.com (212) 710-5076

**Bob Andrews - Senior Vice President - CA, AZ, WA**

bandrews@ktrcapital.com (213) 784-3656

**Kevin Apel - Vice President - Southern CA, AZ, WA**

kapel@ktrcapital.com (213) 784-4429

**Renee Carroll - Asset Manager - NV**

rroll@ktrcapital.com (702) 605-6508

**John Clowney - Vice President - GA, TX**

jclowney@ktrcapital.com (919) 900-8323

**Al Corr - Senior Vice President - PA, NJ, CFL**

acorr@ktrcapital.com (484) 530-1821

**Marty Edmondson - Vice President - IL, OH**

medmondson@ktrcapital.com (847) 737-4841

**Cane Napolitano - Southeast FL**

cnapolitano@ktrcapital.com (954) 354-0249

**Steve Pron - Senior Vice President - Midwest, NV**

spron@ktrcapital.com (484) 530-1851

**Brad Stitchberry - Vice President - Southeast FL**

bstitchberry@ktrcapital.com (954) 354-0290

**Rob Turcott - Vice President - IL, WI**

rturcott@ktrcapital.com (847) 737-4843

# 950 CENTERVILLE ROAD



# KEY LOGISTICS PARK

CUMBERLAND COUNTY | LOCATED IN CENTRAL PA  
IN THE HEART OF THE I-81 DISTRIBUTION CORRIDOR



**Serving 40 million people within 4.5 hours.**

Metropolitan Area	Population	Distance (miles)	Drive Time (hours)	Major Highway Routes
Philadelphia	5,800,000	140	2.5	I-81, I-76
New York Metro Area	17,500,000	200	3.5	I-81, I-80, I-78
Washington DC	5,200,000	120	2	I-81, I-70, I-270
Baltimore	2,600,000	110	2	I-81, I-70
Richmond, VA	1,200,000	221	4	I-81, I-70, I-95
Pittsburgh	2,400,000	175	3	I-81, I-70/76



**570,000 SF Available**

**CUMBERLAND COUNTY  
NEWVILLE, PA**



**950 CENTERVILLE ROAD**  
**570,000 SF AVAILABLE**

FOR MORE  
INFORMATION  
PLEASE  
CONTACT

Michael A. Hess, SIOR  
Senior Vice President  
T 717.540.2705  
michael.hess@cbre.com  
Licensed: PA

Bart D. Anderson  
First Vice President  
T 717.540.2706  
bart.anderson@cbre.com  
Licensed: PA

Patrick M. Lafferty, CCIM, SIOR  
Senior Vice President  
T 717.540.2704  
patrick.lafferty@cbre.com  
Licensed: PA

FOR MORE  
INFORMATION  
PLEASE  
CONTACT

Michael A. Hess, SIOR  
Senior Vice President  
T 717.540.2705  
michael.hess@cbre.com  
Licensed: PA

Bart D. Anderson  
First Vice President  
T 717.540.2706  
bart.anderson@cbre.com  
Licensed: PA

Patrick M. Lafferty, CCIM, SIOR  
Senior Vice President  
T 717.540.2704  
patrick.lafferty@cbre.com  
Licensed: PA



# 950 CENTERVILLE ROAD



# KEY LOGISTICS PARK

- 80.046 Acres
- 32' Minimum Clear Height
- 48' x 50' Standard Bay Size; 60' x 50' at Staging Bays
- 62 – 9'x10' Dock Doors with 6' x 8' 35,000 lb. Vertical Levelers, Expandable to 120
- 2 – 12' x 14' Drive-In Doors
- T-5 Lighting
- ESFR Sprinkler System
- 4 Horizontal Wall Mounted Cambridge Heating Units
- Steel Frame Construction with Precast Insulated Wall Panels
- Ballasted .045 EPDM Membrane Roof
- 277/480 Volt, 3-Phase 2,500 amp Electrical
- 249 – Car Parking Spaces
- 82 – Trailer Parking Spaces, Expandable to 140
- 60' Concrete Dock Aprons and 10' Wide Continuous Concrete Truck-Dolly Pads
- 7" Concrete Floor Slab, 4,000 PSI Concrete Mix Design
- Floor Finished with High Reflective Value and Overall Average FF69.48/FL40.50
- First Two Bays (110') on Each Dock Side Reinforced with 5/8" x 12" Steel Dowels at All Floor Points

## RECENT IMPROVEMENTS:

- 2,655 SF spec office
- Warehouse bathrooms
- T5 lighting with motion sensors
- Dock seals
- Additional car parking area with employee-only entrance

## PERMITS IN PLACE FOR:

- 32 additional dock doors
- Completion of trailer parking on both sides of the building
- Future paving for additional dock doors

570,000 SF AVAILABLE  
30,000 SF PER BAY

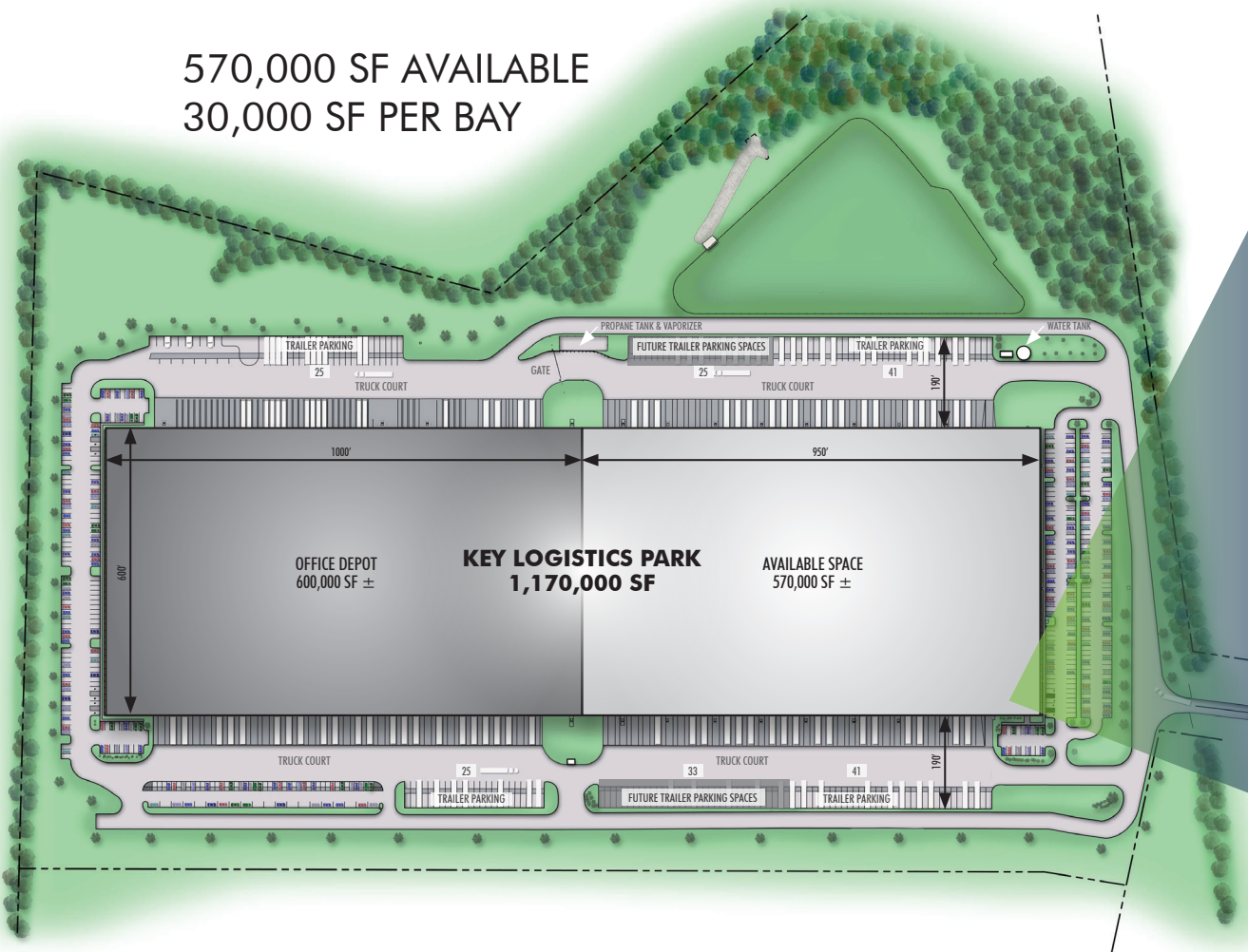

## Recent improvements include:

- 249 car parks recently expanded
- 2,655 SF office

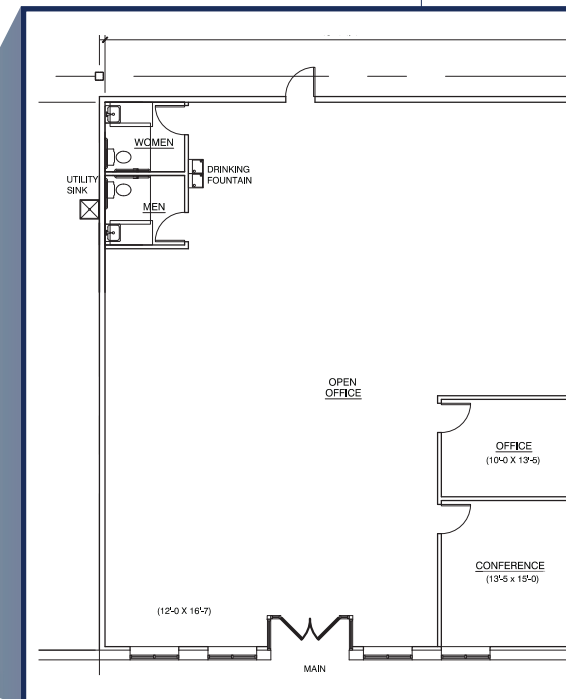

Centerville Road  
0.64 Miles to I-81 - Exit 37

